

SR5

en-EN Assembly instructions

Table of contents

Before starting	2	Mounting accessories	82
Personal configuration	3	Plastic slide at top	82
Intermediate view	3	Plastic slide at bottom	83
Top view of SoboPro	4	Plastic slide at bottom 04-0 FB03	84
Overall view	4	Plastic slide at bottom and top	85
Installing SoboPro	5	Divider for shelf	86
Preparing profiles	8	Divider for shelf with border	87
Attaching components	13	Shelf for universal cabinet	88
90° dual directional block ..	57	Worktop shelf	89
How to attach the racking ..	65	Mounting side profile	
EcoFiX — What is it?	65	accessories	90
Attaching the EcoFiX bracket to		Logo	90
the block system	66	Storage pocket	91
Connecting the rear wall profile	70	Storage pocket for paperwork	92
Extending the rear wall profile	74	Paper towel dispenser	93
Attaching EcoFiX brackets to		ProSafe lashing rail	94
the vehicle wall	76	Hook strip	95
Determining the number and position	78	Hose holder	96
Attaching the block	79	i-BOXX wall holder	97
		Mounting intermediate profile	
		accessories	98
		Storage pocket	98
		Storage pocket for paperwork	99
		Paper towel dispenser	100
		ProSafe lashing rail	101
		Hook strip	102
		Hose holder	103
		i-BOXX wall holder	104

Before starting



CAUTION

Injury from lifting too heavy a load

The block can be too heavy for one person depending on the configuration. This could result in minor injuries.

- Installation should be carried out by two persons.

Recommendation

Depending on the configuration, several block systems are included in the delivery. We recommend that you install them separately from each other.

Workplace

Make sure that your working environment is safe. Position the vehicle on flat solid ground.

Screw locking device

If the vehicle is to be driven off normal roads, all screw connections must be attached using a suitable screw locking device.

Service access points

Make sure when installing the van racking that all available service access points (e.g. first aid kit, spare wheel) remain accessible after installation.

Personal configuration

The “Personal configuration” document is included with delivery. This document contains additional information about the installation of your personal configuration. The parts of this document are described below.



When the following symbol appears, the corresponding information must be taken from the “Personal configuration” document.

Intermediate view

The intermediate view shows the position of the installation adapters for the profile of the configuration.



A 95 <	B 95 <	B 95 >	
			1)
			2)
			3)
-	-	-	
-	92	-	
-	76	-	
-	66	-	
-	64	-	
-	60	-	
-	58	-	
-	54	-	
-	52	-	
-	46	-	
-	44	-	
-	26	-	
4	40	-	

- 1) Designation
- 2) Grid position
- 3) Installation adapter

There are two different installation adapters:

- Installation adapter with lug
The installation adapter with lug is solely used to attach **shelves**.
- Installation adapter without lug
This installation adapter is used to install the remaining elements, e.g. **frame** or **traverse frame**.

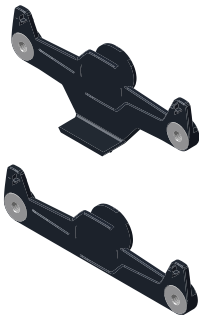

Top view of SoboPro

This view shows the SoboPro, the side profiles and the intermediate profiles from above. The side and intermediate profiles are clearly marked. This illustration also provides the height information for the individual side and intermediate profiles.

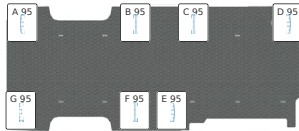

Information on the individual profiles:

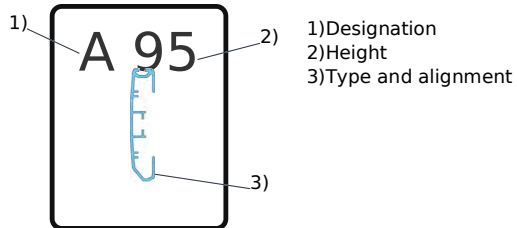

Overall view

The overall view shows your van racking from each side and in the isometric view. Each field is displayed separately. The designation of the field comes from the respective profile pair.

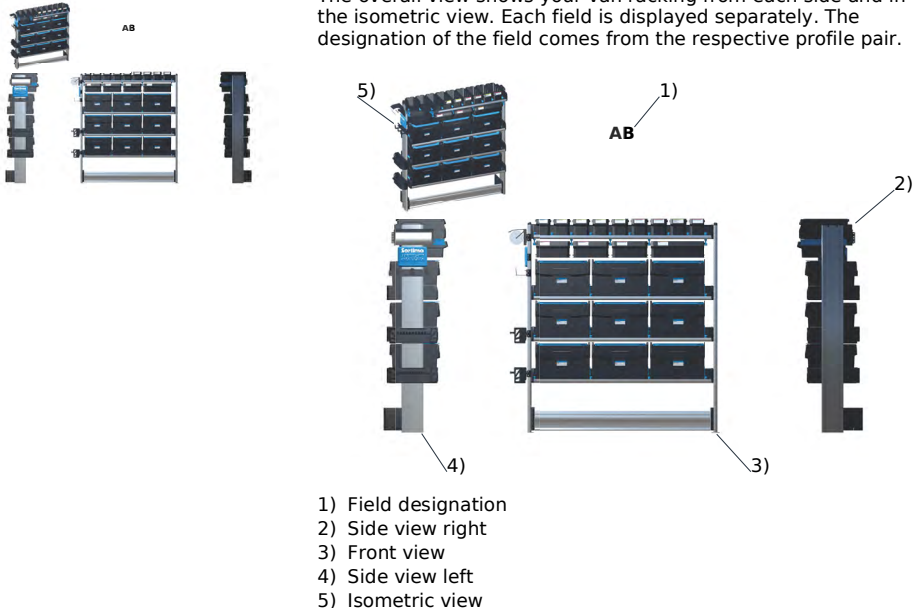

Installing SoboPro

ATTENTION

Damage caused by rough handling.

The connection folds of the floor panels are sensitive to bumps and crushing.

- ▶ Connect the floor panels carefully.

Step 1 — Preparing the vehicle

Note: If your vehicle has a floor cladding, it needs to be removed.

- ▶ Remove the lashing eyes in the floor area.

Note: Keep the components of the lashing eyes that have been removed for subsequent re-assembly.

- ▶ Clean the vehicle floor.

Step 2 — Positioning the floor panels

- ▶ Check whether or not the floor panel folds are damaged.
- ▶ Position the first floor panel.

Note: This is laid from the divider to the rear of the vehicle.



- ▶ Position the next floor panel.
- ▶ Fit the floor panels together.

Note:

- The connecting ends must be flush.
- Make sure that the cut-outs line up with each other.

- ▶ If available, position additional floor panels one by one and connect to the previous ones.

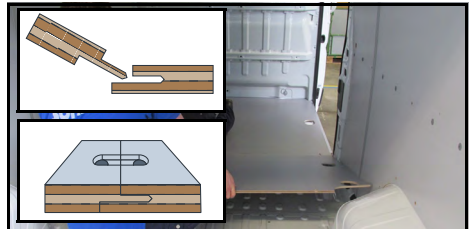

Step 3 — Attaching floor retainer clips

- ▶ Position the floor retainer clip.
- ▶ Carefully use a rubber hammer to secure the floor retainer clip.
- ▶ Repeat these steps until all floor panels have been connected to each other.

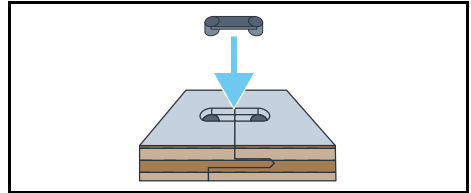

Step 4 — Aligning floor panels

- ▶ Align adjoining floor panels.

Note: The floor must have the same gap from the vehicle chassis in all directions. The following can be of assistance in this regard:

- Lashing points,
- Wheel housings.

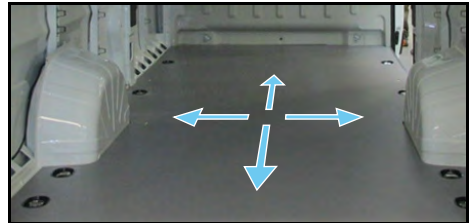

Step 5 — Attaching lashing eyes

- Assign the lashing eyes with their original screws to the original positions.

Note: The floor panel requires the installation of a lashing rail. The lashing rail may need to be raised using shims depending on the floor of the vehicle chassis.

- Determine the number of shims.

Note: The number of shims should ensure that the floor panel is slightly pressed.

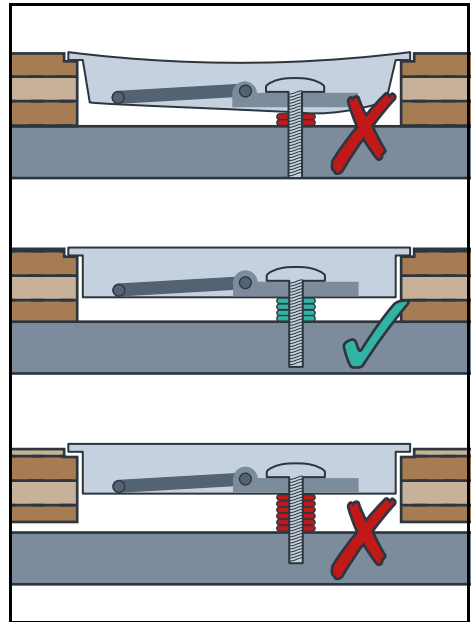

- Tighten the original screws using the required torque.

Note: The respective torque can be found in the manufacturer's set-up guidelines.

Preparing profiles

Step 1 — Assigning profile feet

Note: There are three different types of profile feet. The number and type of the profile feet depends on your configuration.

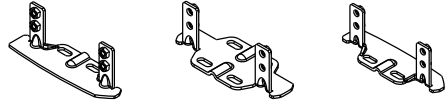

- Assign the corresponding profile foot to each side profile / intermediate profile.

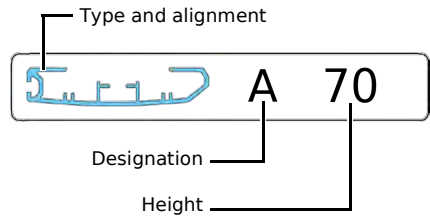

Step 2 — Attaching profile feet



- Attach the profile foot to the profile.

1

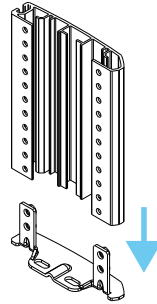

2

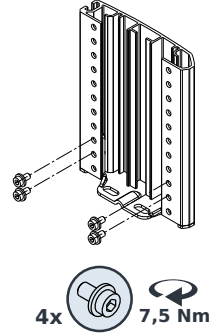

Step 2 — Attaching profile feet

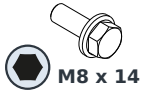

- Attach the profile foot to the SoboPro.

3

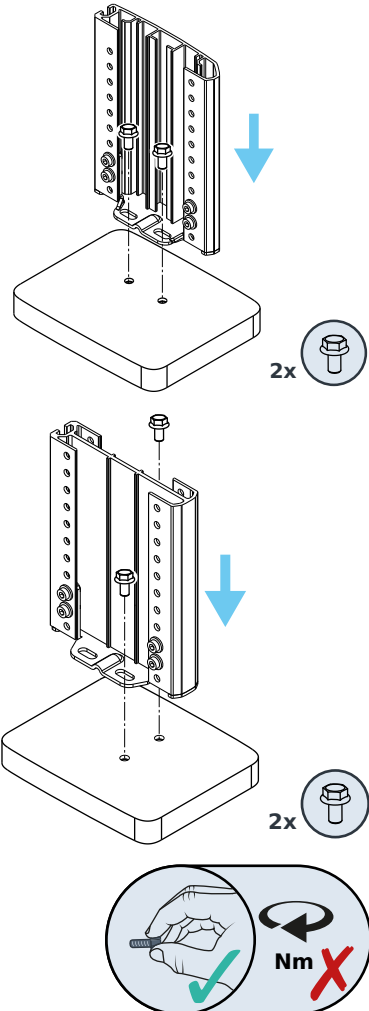

- Repeat these steps until all profile feet have been attached.

Step 3 — Positioning the installation adapter

- Determine the position.

Note: The Sortimo folding rule supplied can be used to measure the grid height.

Note: There are two different installation adapters. The symbol indicates which installation adapter should be used.

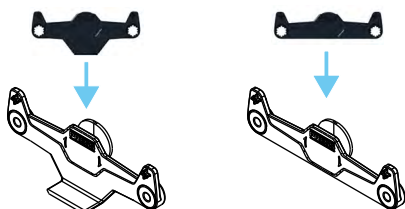

- Insert the installation adapter into the profile.

1

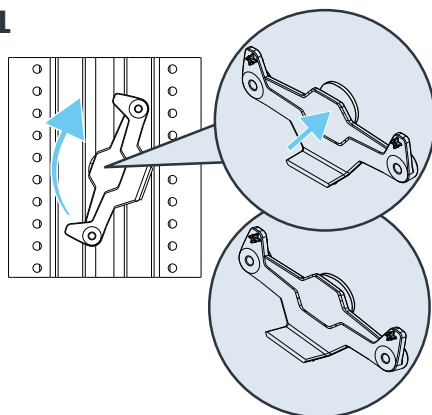

2

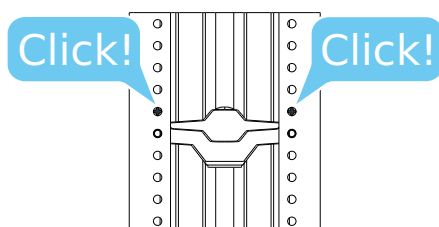

Step 3 — Positioning the installation adapter

- Position the installation adapter.

Note: Pressing on the "Press" surface lets you position the installation adapter at the corresponding height.

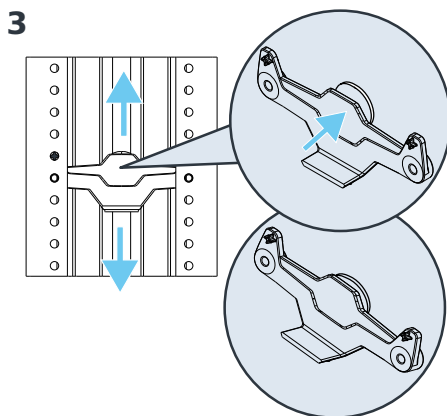

4

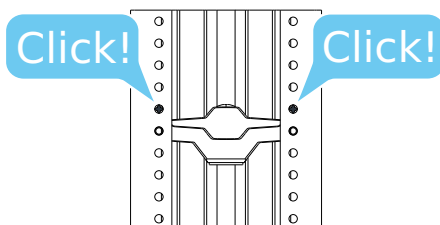

- Repeat these steps until all installation adapters have been positioned.

Attaching components

The following elements are attached between the profiles:

- a) Frame,
- b) Traverse frame,
- c) Shelf,
- d) Drawer H8/H10/H12,
- e) Drawer H6,
- f) SR drawer,
- g) MultiSlide,
- h) Field subdivision,
- i) Case fixation,
- j) Base plinth,
- k) Base plinth with floor lashing rail,
- l) Floor flap,
- m) Floor flap with floor lashing rail,
- n) Universal cabinet,
- o) Hinged work bench,
- p) Long components tray,
- q) Case rail.

Note: Certain elements are not included in the delivery, depending on the configuration.

Attaching frames

The frame stabilises the field in which it is installed. The configuration of your block defines whether or not a frame is required. The following elements are decisive:

- Drawer
- MultiSlide
- SR drawer

Rule: This applies to the following rules: Each field must be taken into account separately.

Rule A: If more than two of the elements listed above are mounted, then a minimum of one frame or shelf needs to be fitted at the top and bottom. Rear wall profiles also need to be fitted, thereby taking into account the permissible installation options for the rear wall profiles.

Rule B: Each of the elements listed above have a specific grid height. If several elements are installed and the total grid height of these elements is equal to or more than 60, then two frames, one shelf and rear wall profiles need to be attached.

Rule C: If up to a maximum of two of the elements listed above are installed, then a frame or shelf needs to be fitted at the top and bottom. No rear wall profiles are needed in this case.



- ▶ Determine the position.
- ▶ Position the frame between the installation adapter pair.
- ▶ Secure the frame to the profiles with screws.

- ▶ Repeat these steps until all frames have been attached.

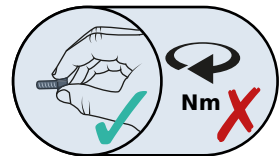
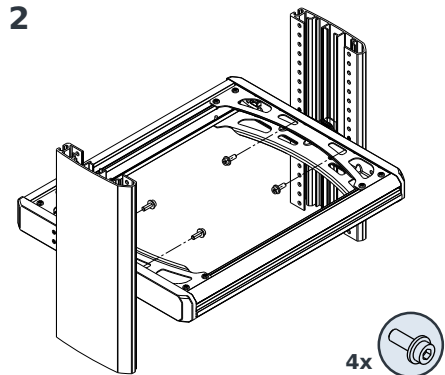
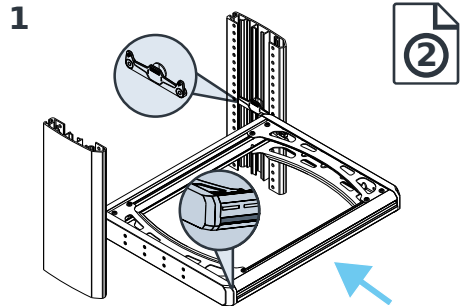

Attaching traverse frames



- ▶ Determine the position.
- ▶ Position the traverse frame between the installation adapter pair.
- ▶ Secure the traverse frame to the profile with screws.

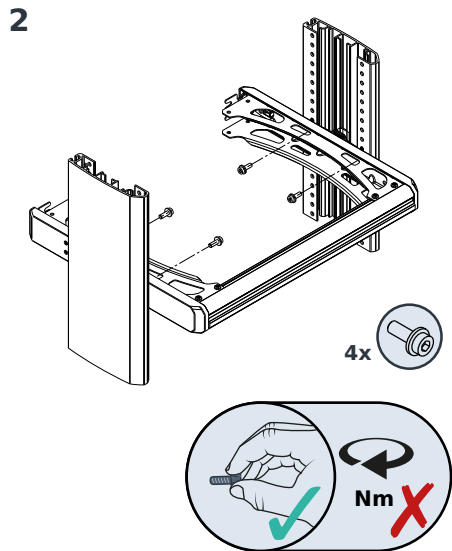
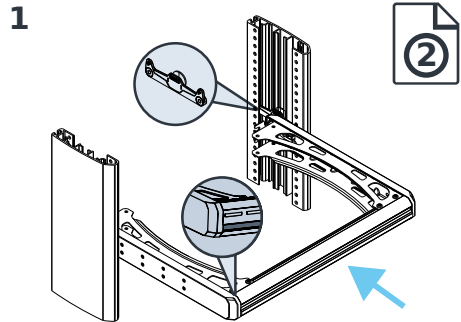

- ▶ Repeat these steps until all traverse frames have been attached.

Attaching shelves



- Determine the position.
- Position the shelf between the installation adapter pair.
- Secure the shelf to the profiles with screws.

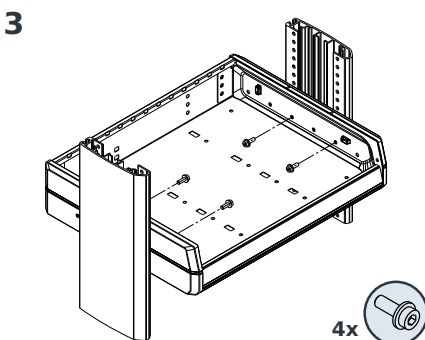
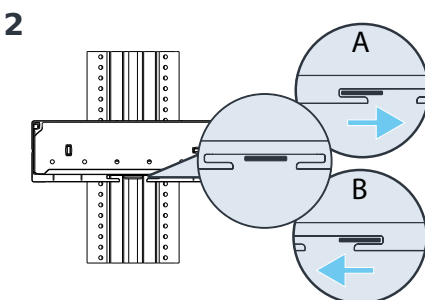
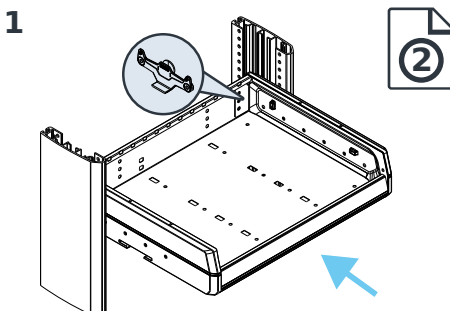

- Repeat these steps until all shelves have been attached.

Fitting the drawer H8/H10/H12

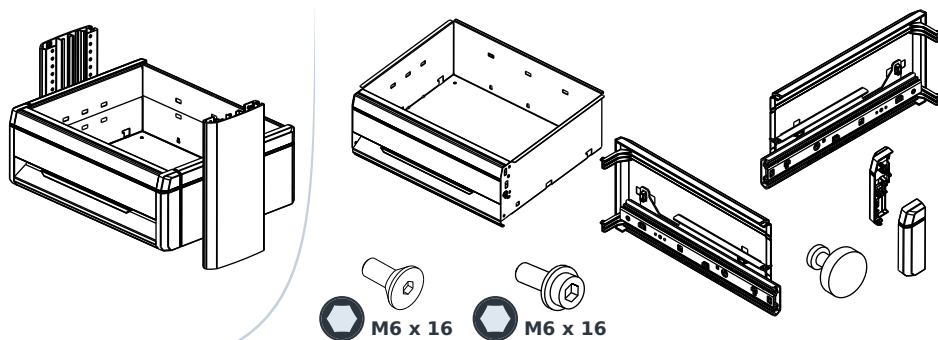

1

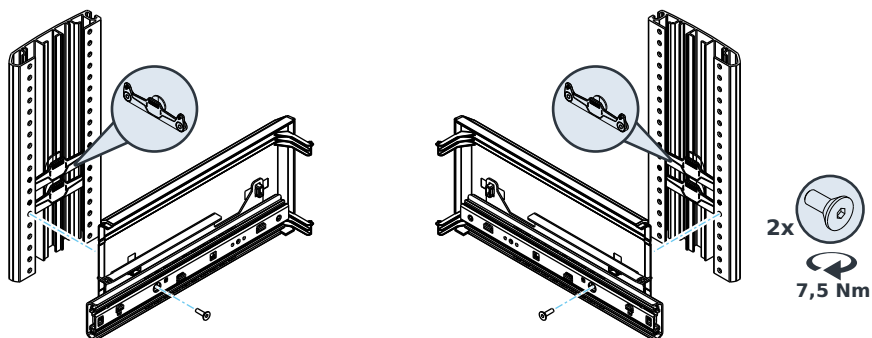

2

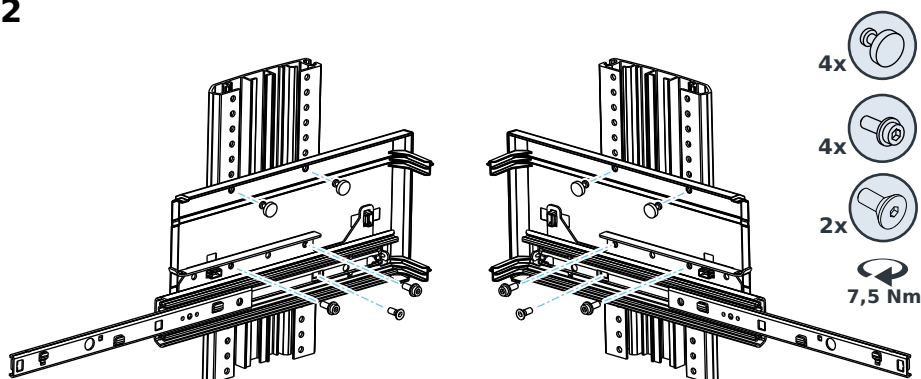

Fitting the drawer H8/H10/H12

3

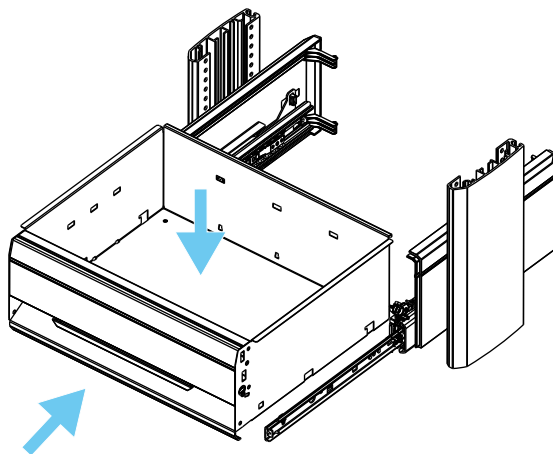

4

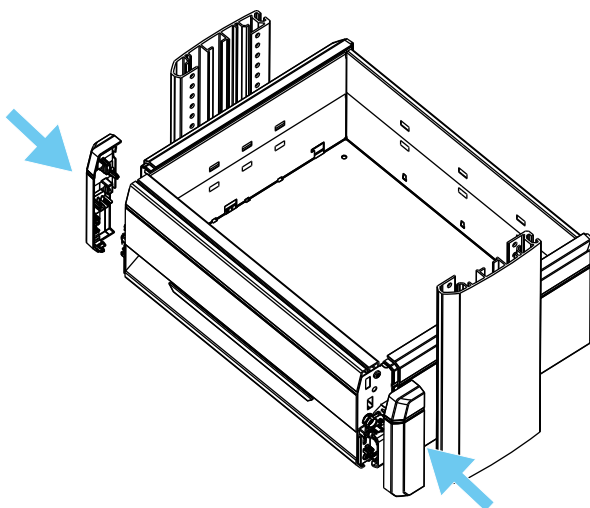

Fitting the drawer H6

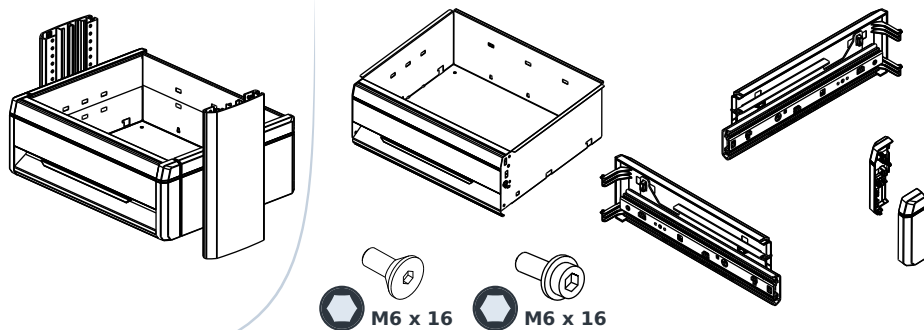

1

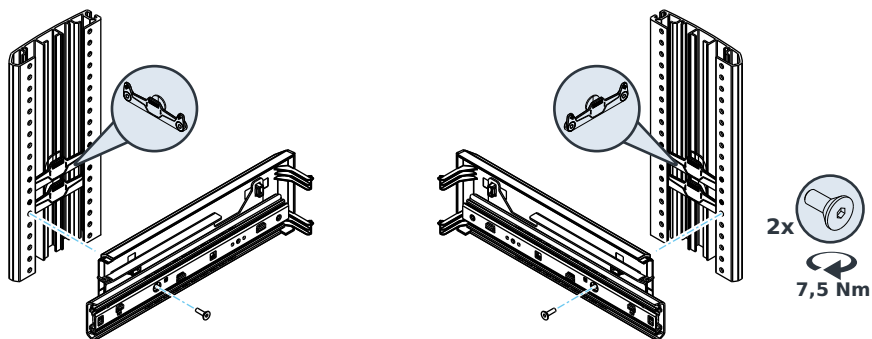

2

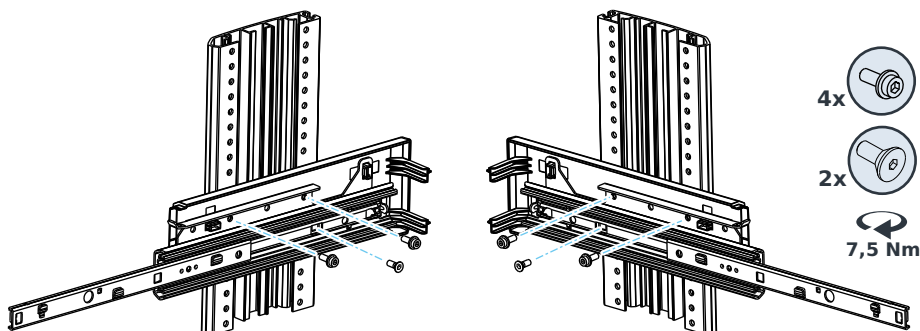

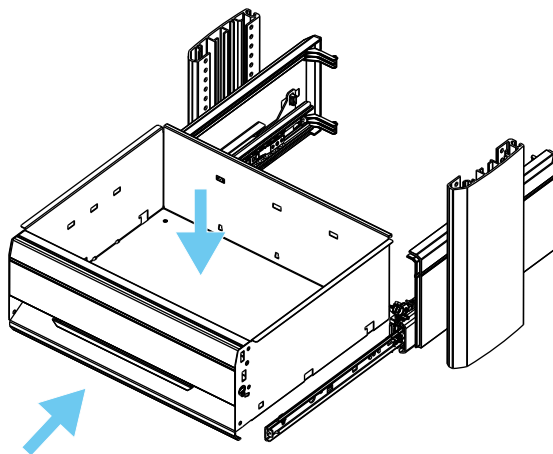
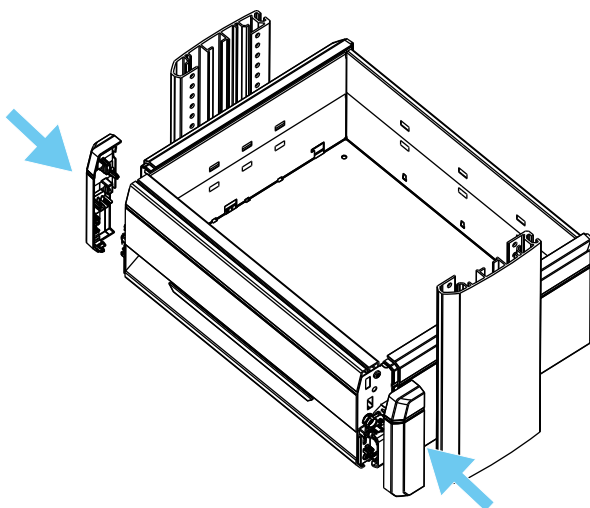
Fitting the drawer H6**3****4**

Fitting the SR drawer

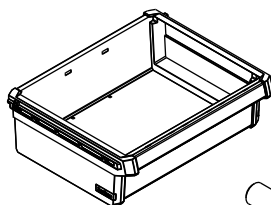
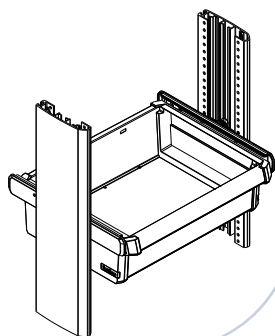

1

2

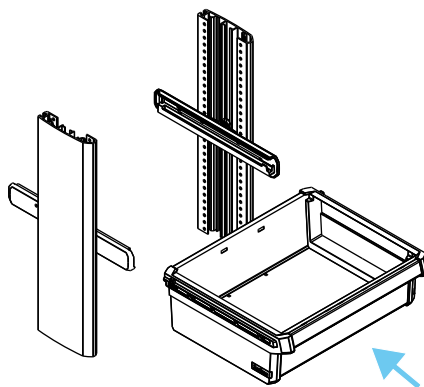
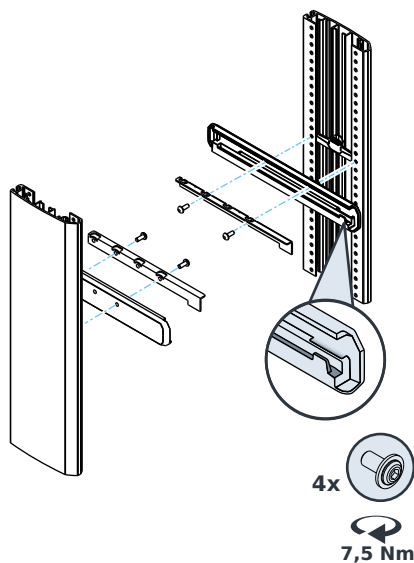

Fitting the MultiSlide

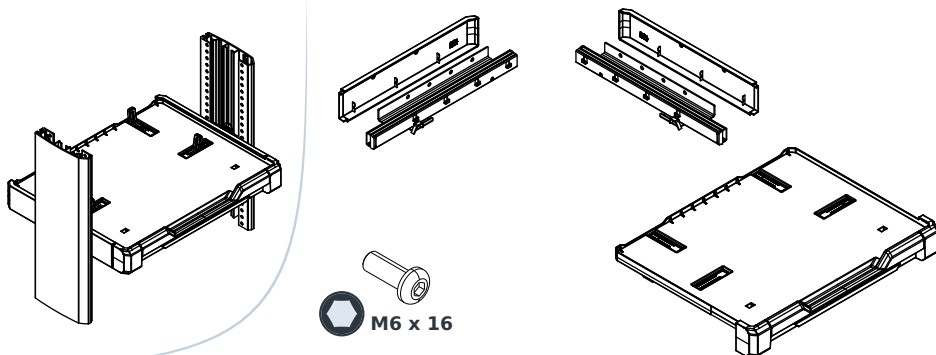

1

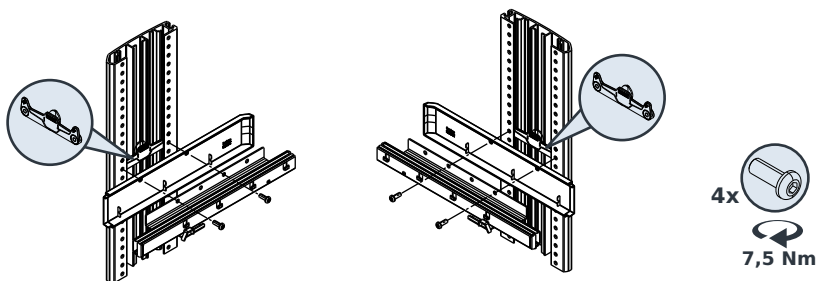

2

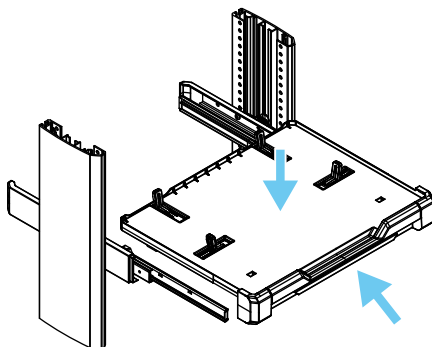

Installing field subdivisions — frame + frame

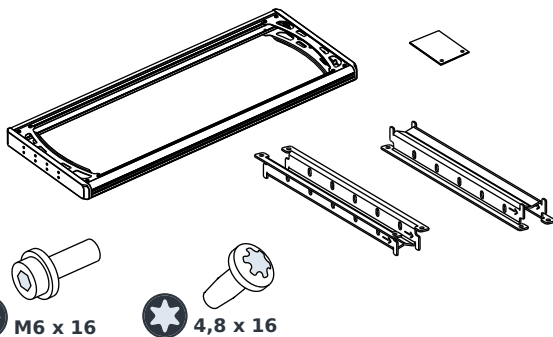
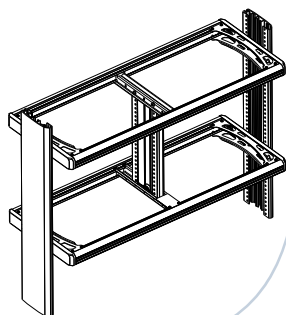

1

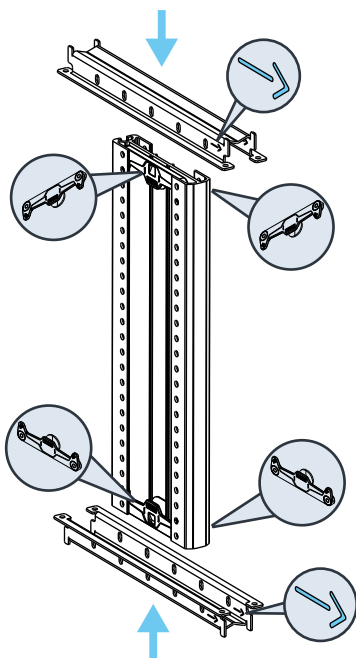

2

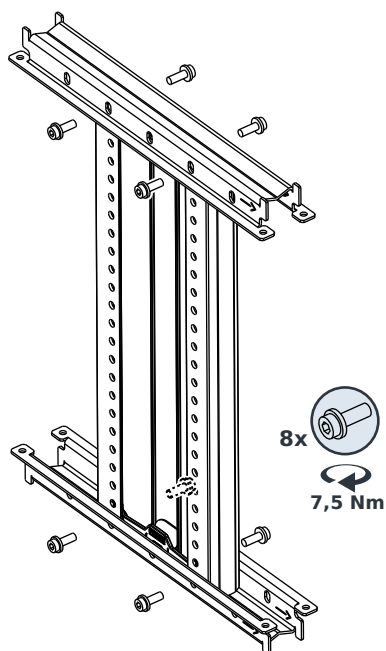

Installing field subdivisions — frame + frame

3

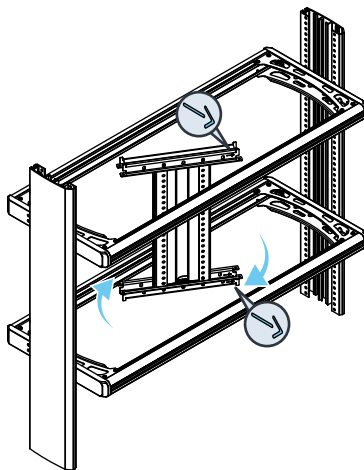

4

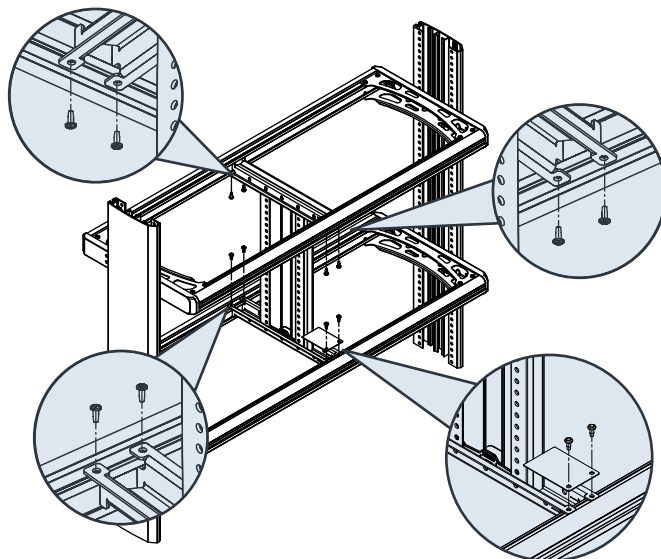

Installing field subdivisions — frame + shelf

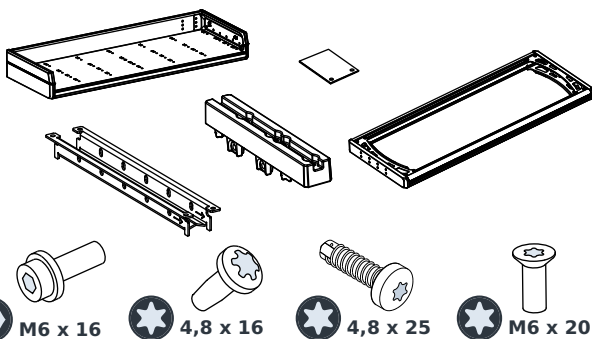
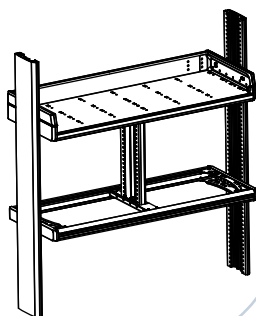

1

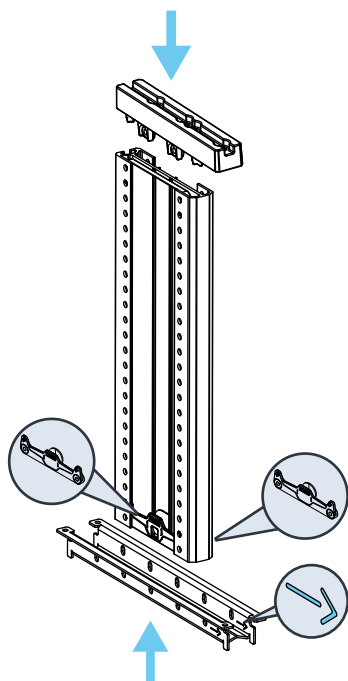

2

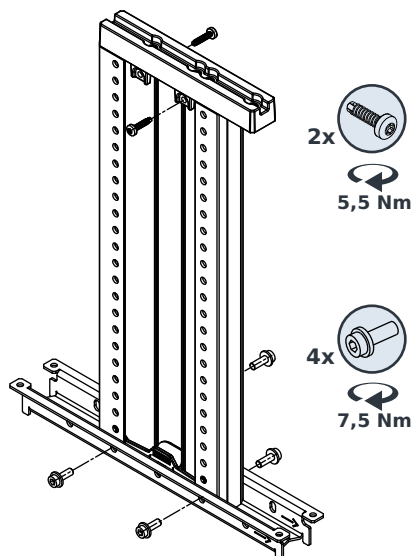

Installing field subdivisions — frame + shelf

3

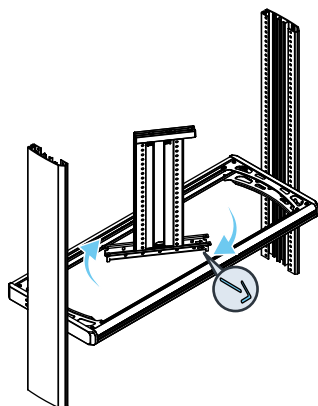

4

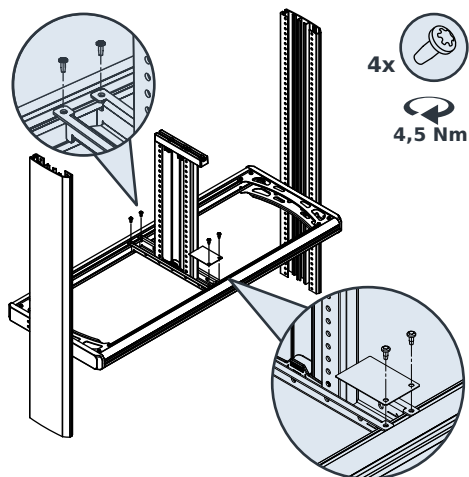

5

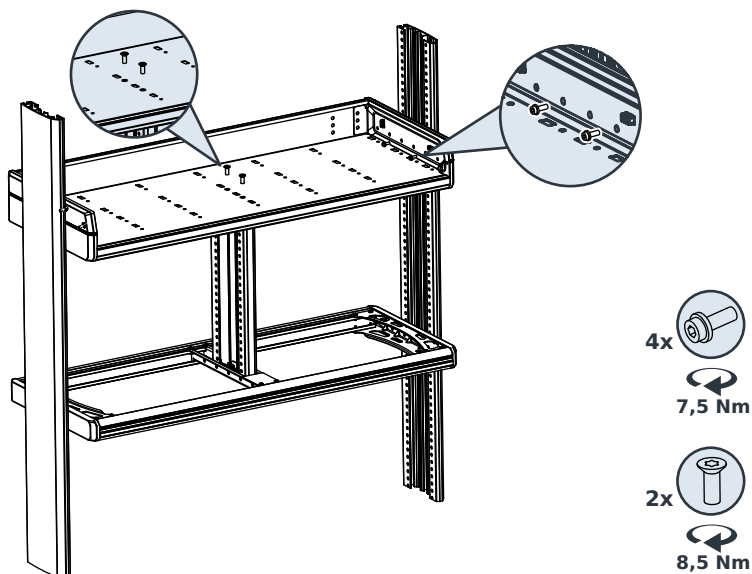

Fitting the case fixation

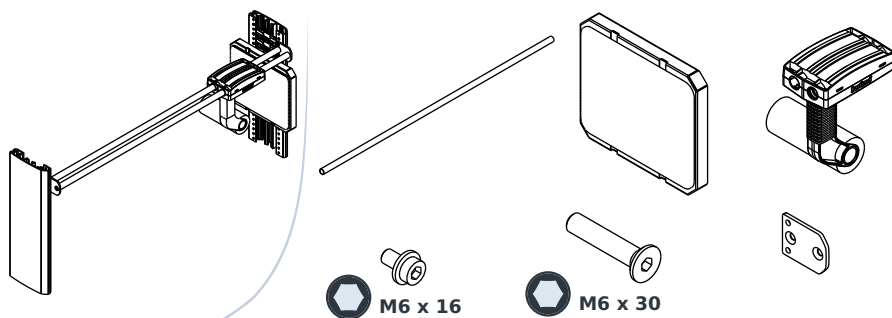

1

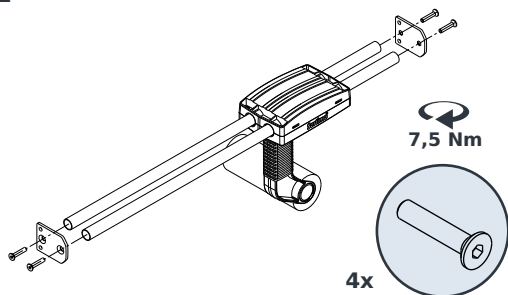

2

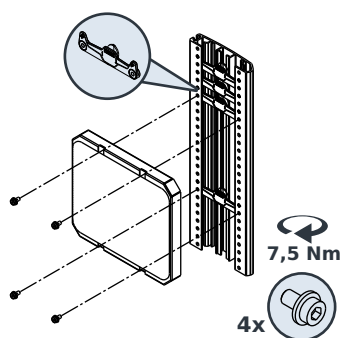

3

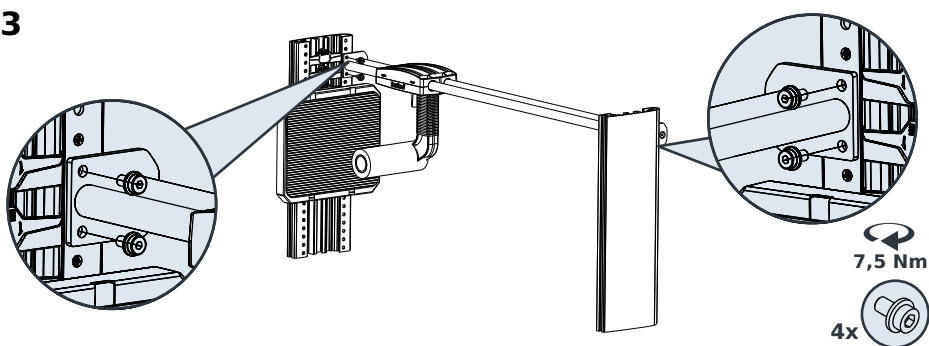

Base plinth

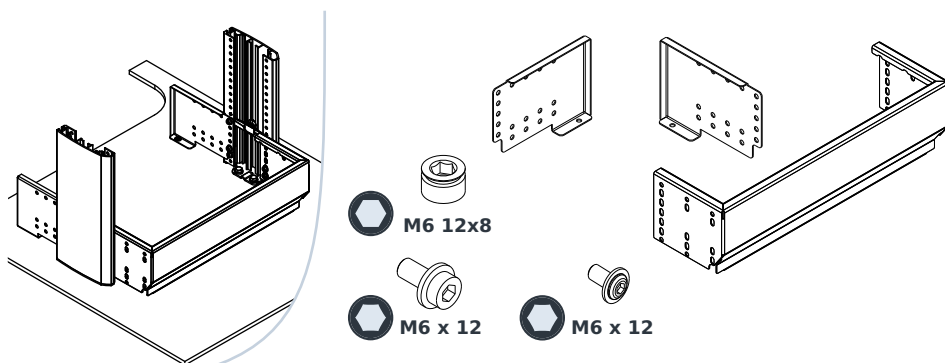

1

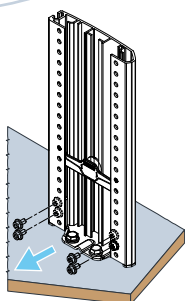

2

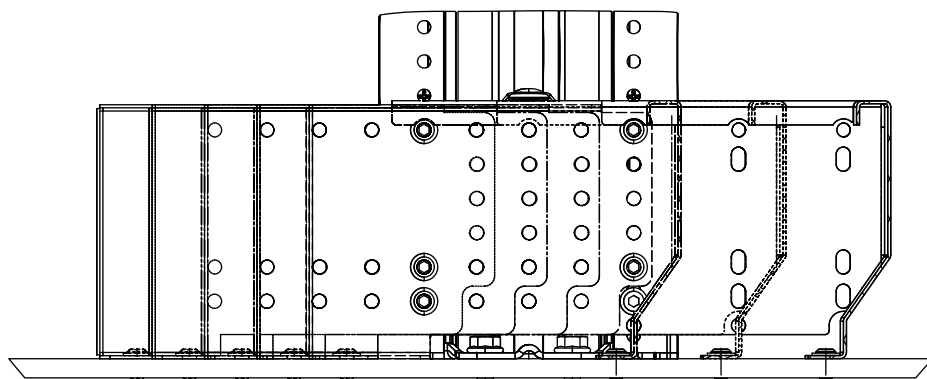
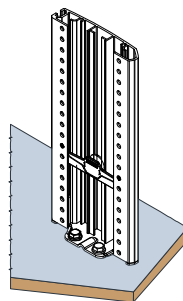

Base plinth

3

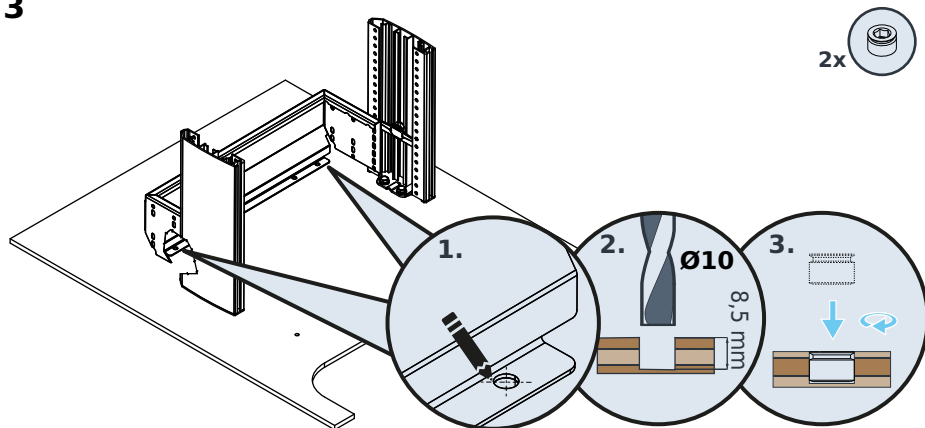

4

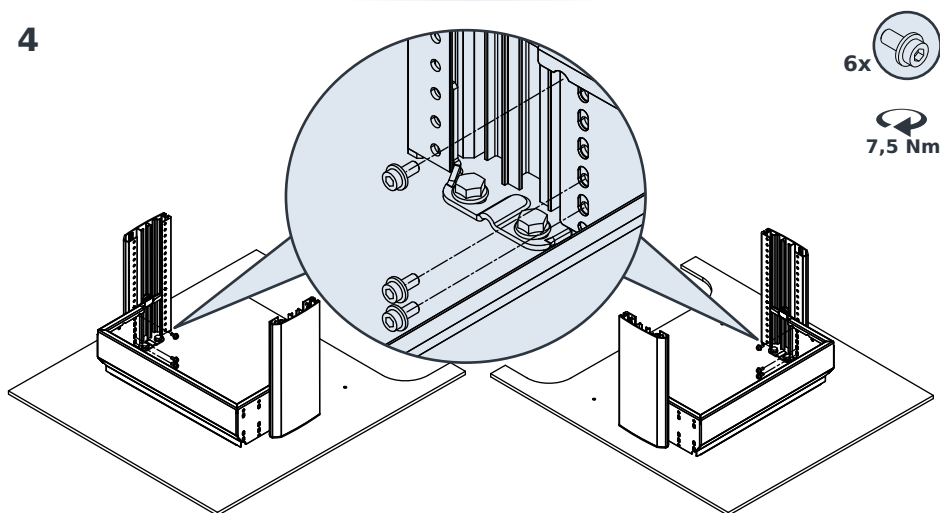

Base plinth

5

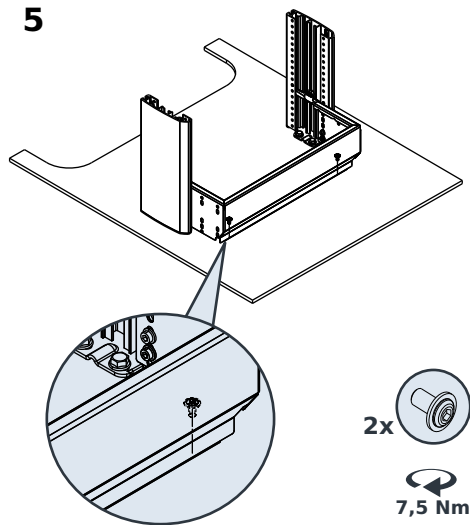

6

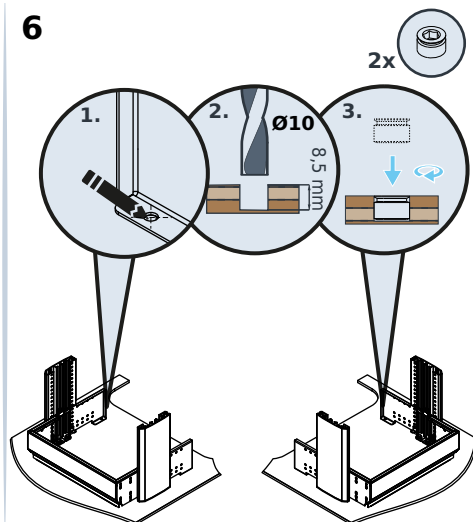

7

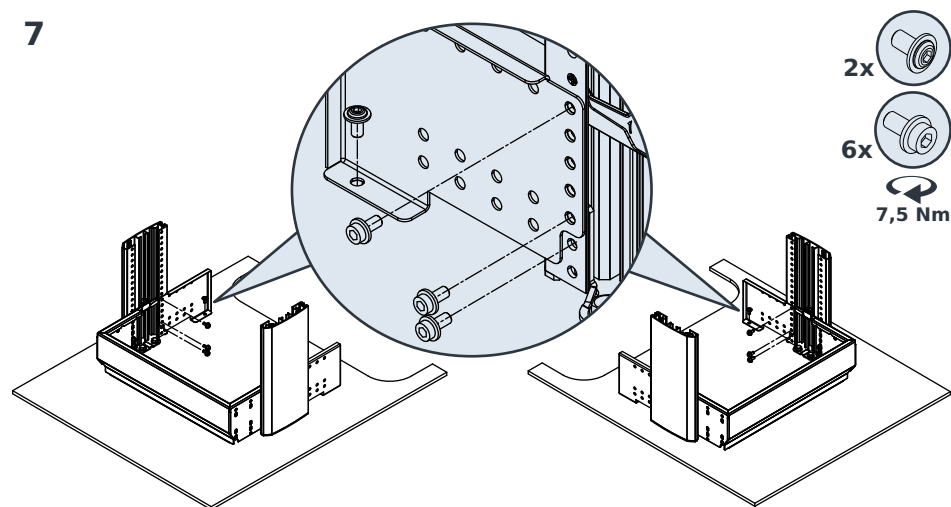

Base plinth with floor lashing rail

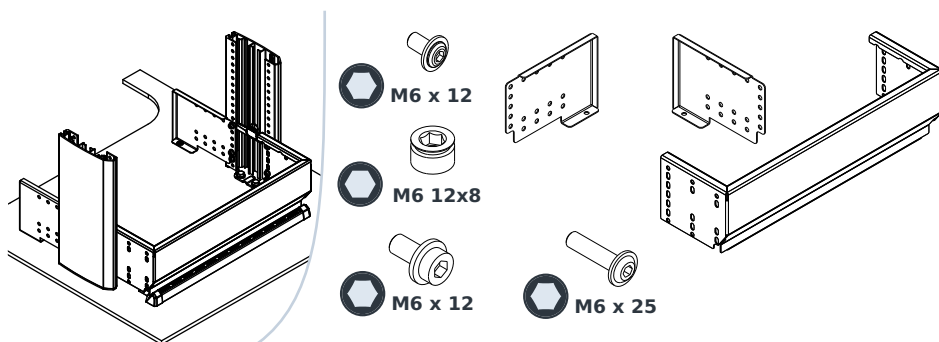

1

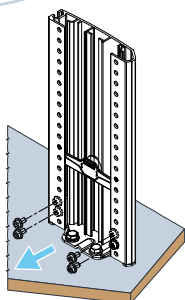

2

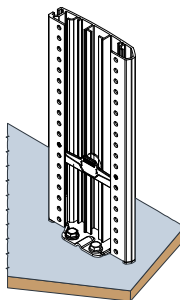

3

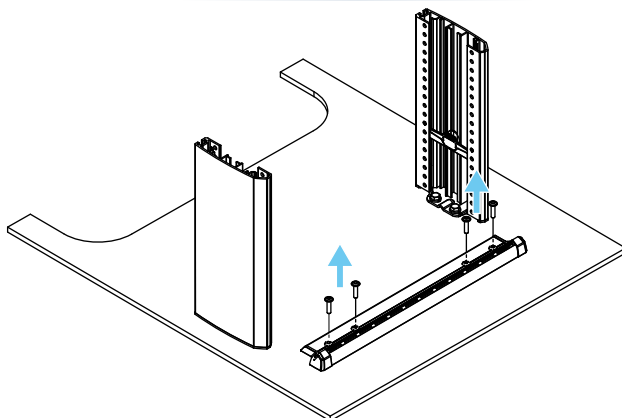

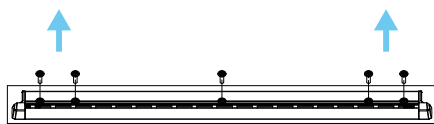
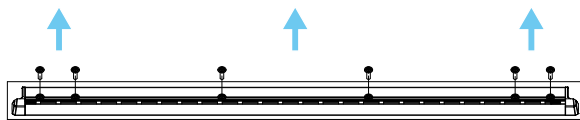
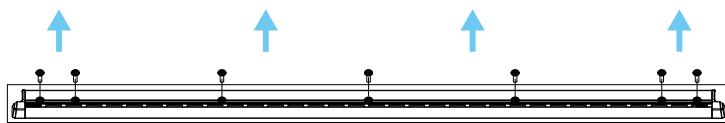
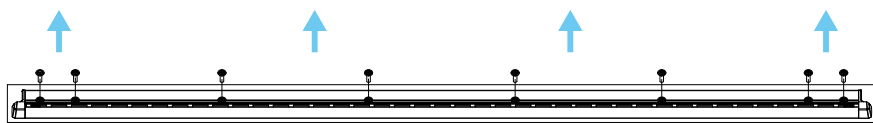
Base plinth with floor lashing rail**20-2****30-2****40-2****50-2****60-2**

Base plinth with floor lashing rail

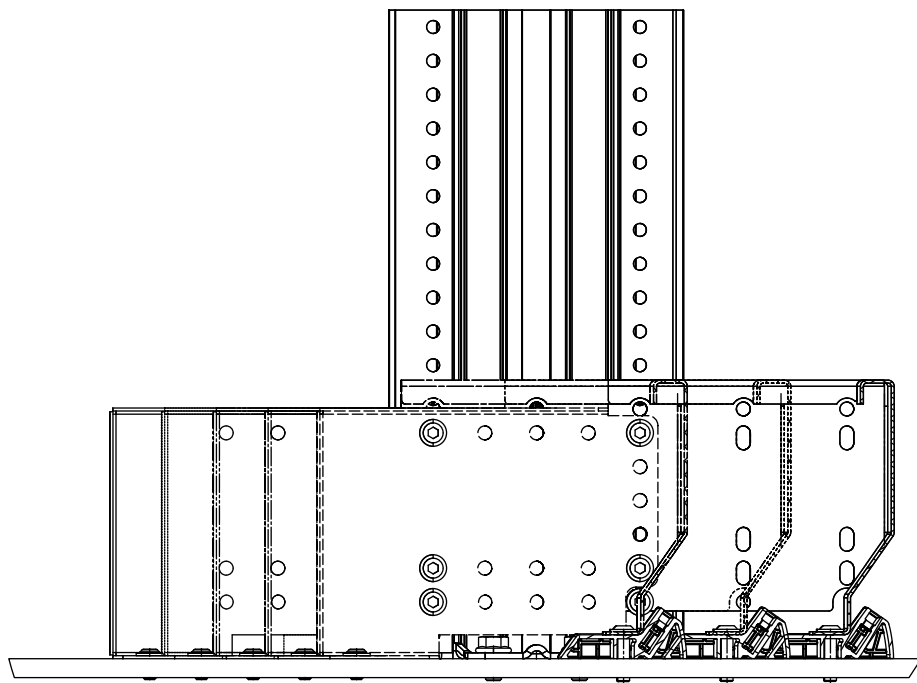

Base plinth with floor lashing rail

4

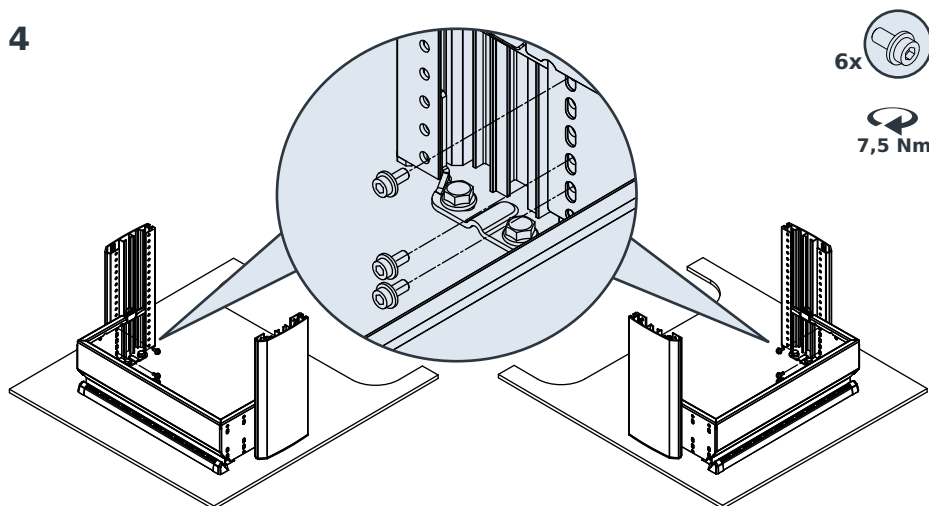

5

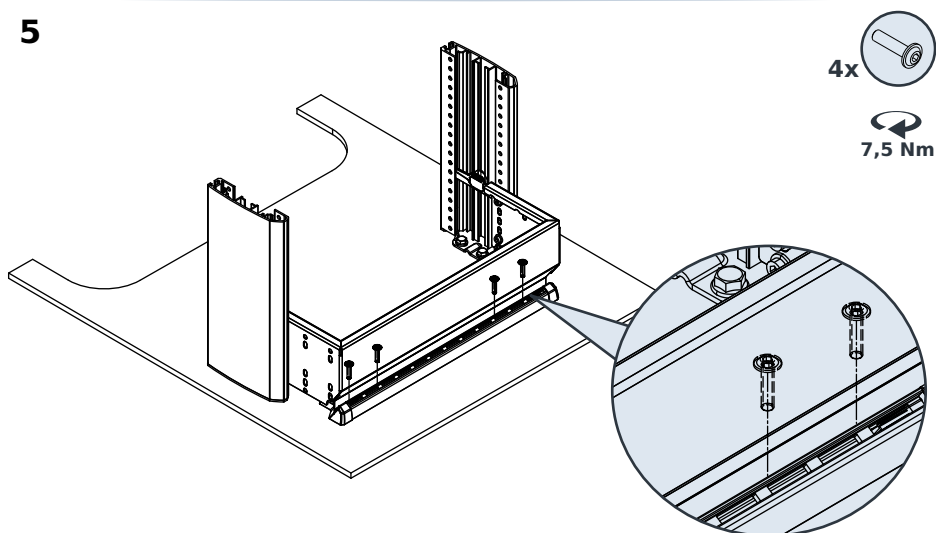

Base plinth with floor lashing rail

20-2



30-2

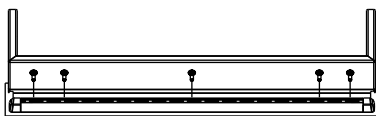

40-2



50-2

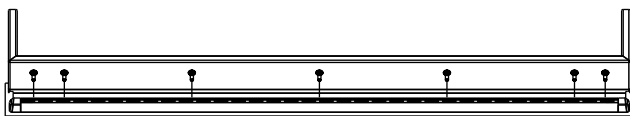

60-2



Base plinth with floor lashing rail

6

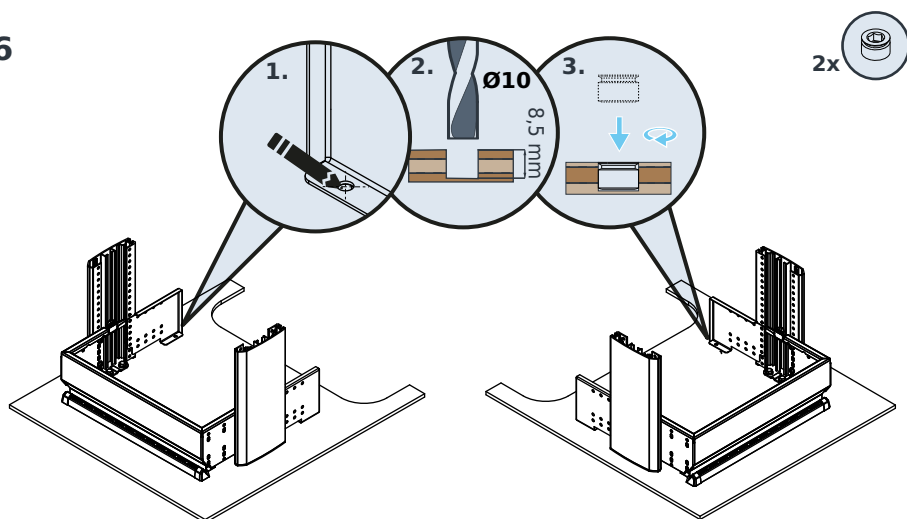

7

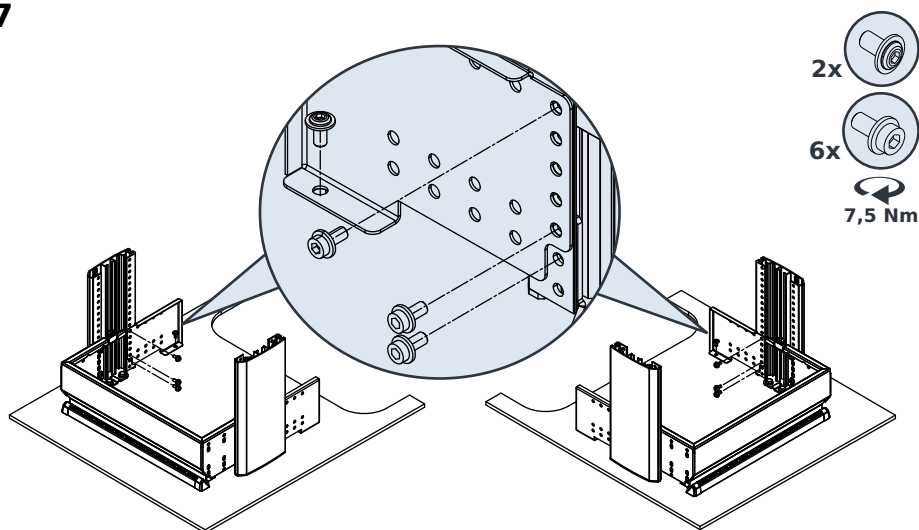

Floor flap

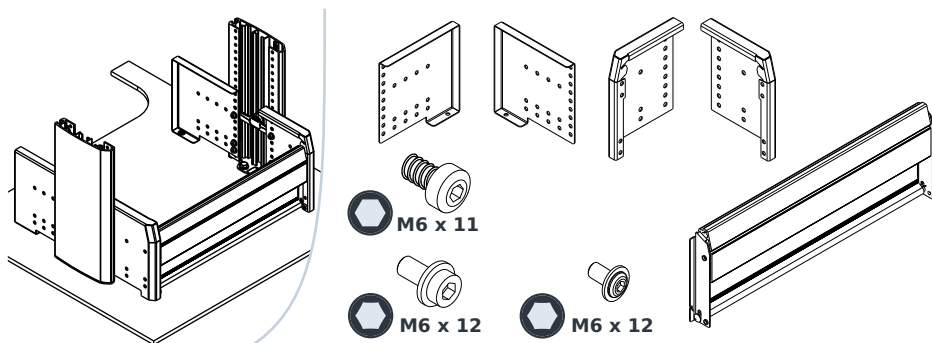

1

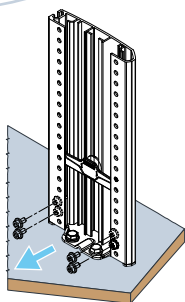

2

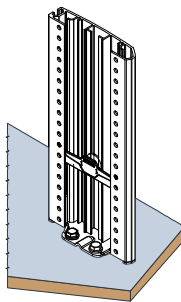

3

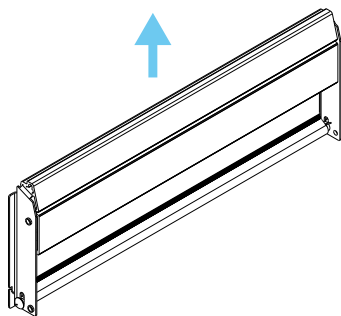

4

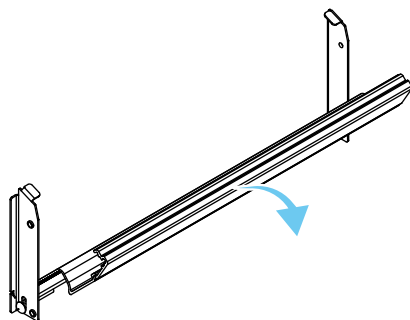

Floor flap

5

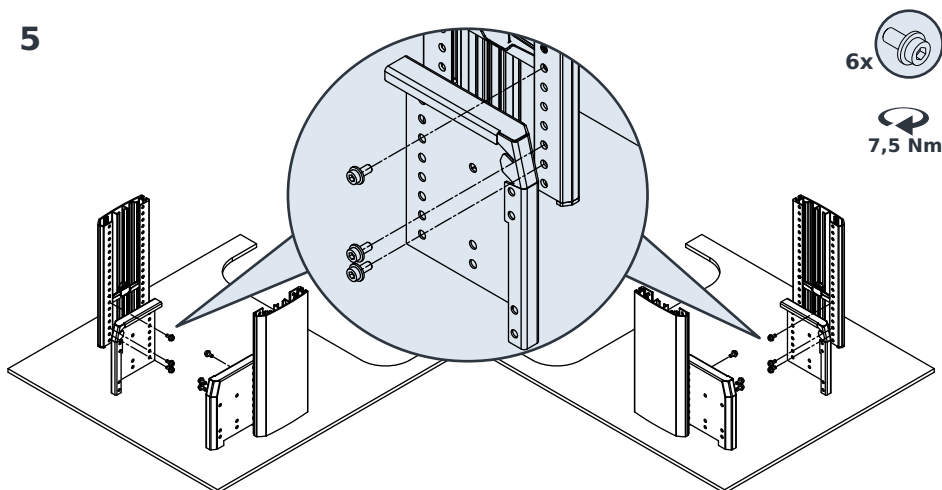

6

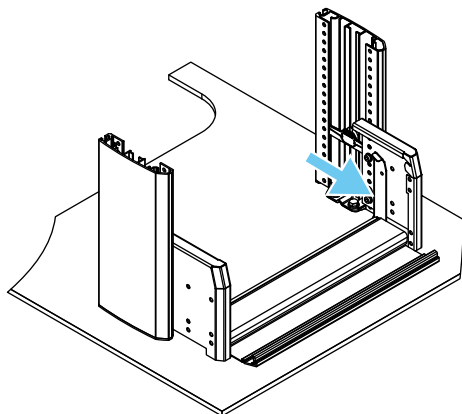

7

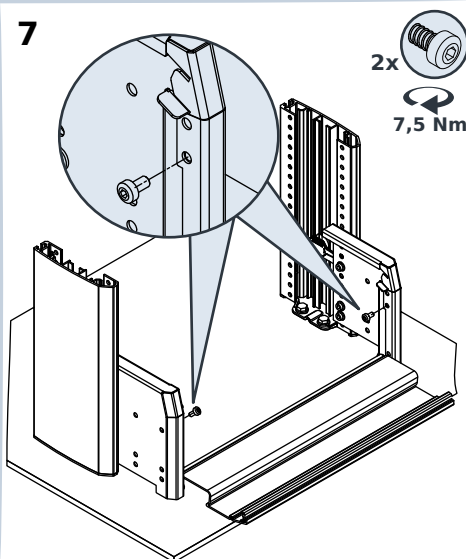

Floor flap

8

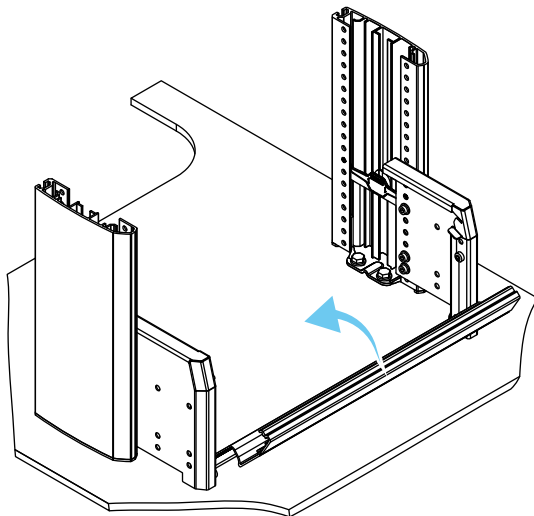

9

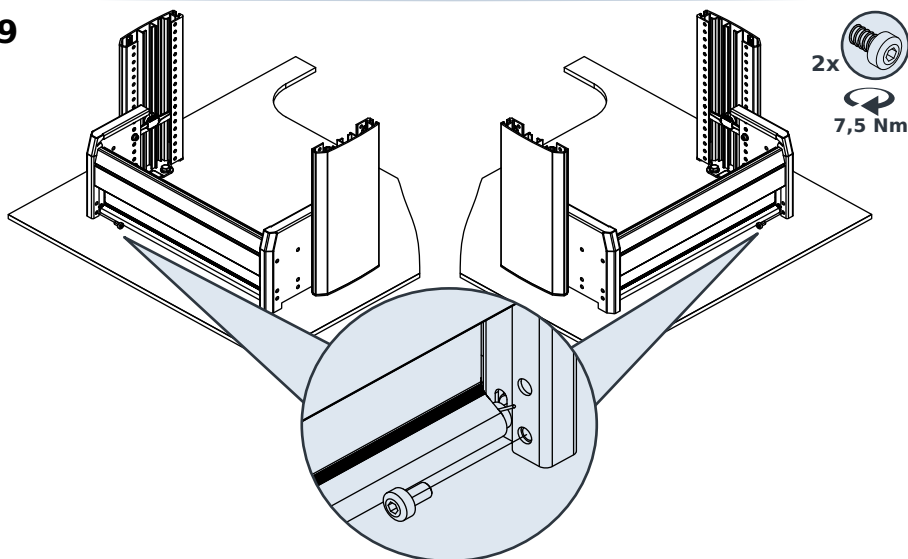

Floor flap

10

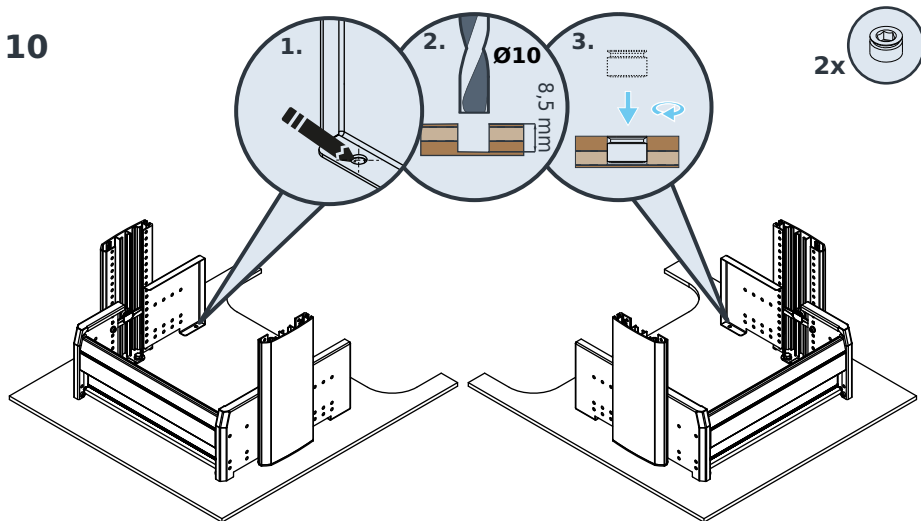

11

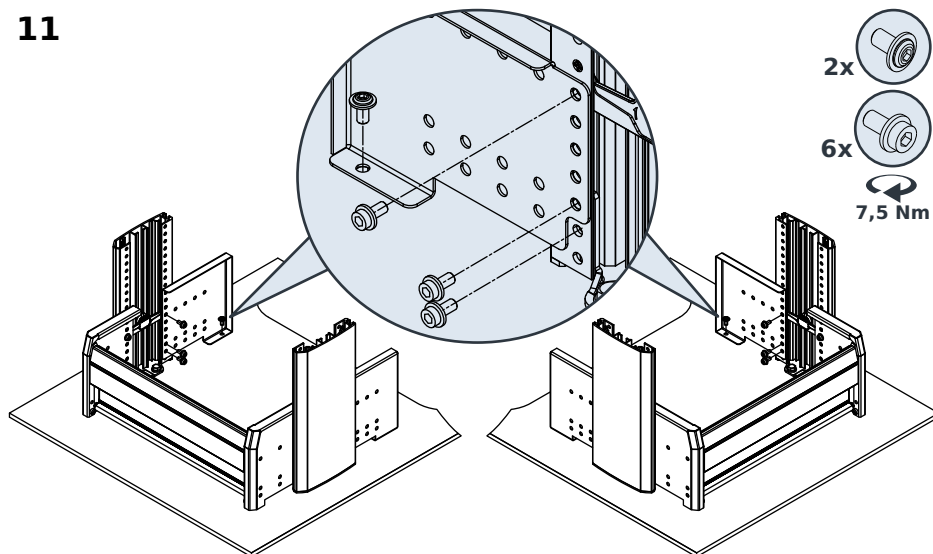

Floor flap with floor lashing rail

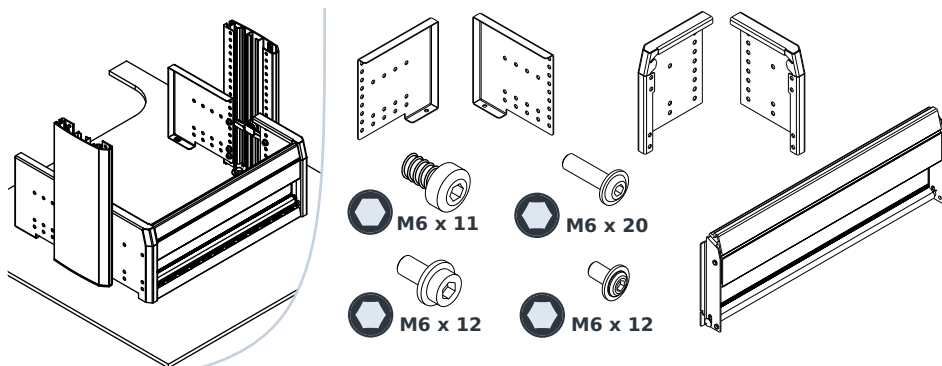

1

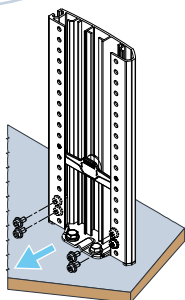

2

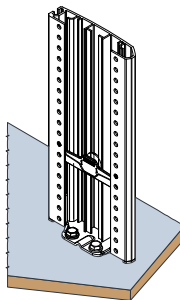

3

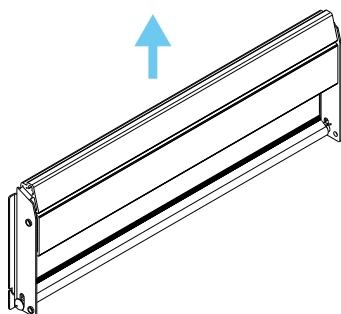

4

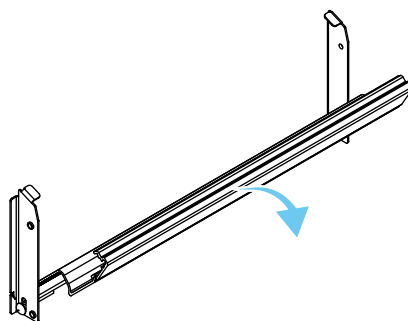

Floor flap with floor lashing rail

5

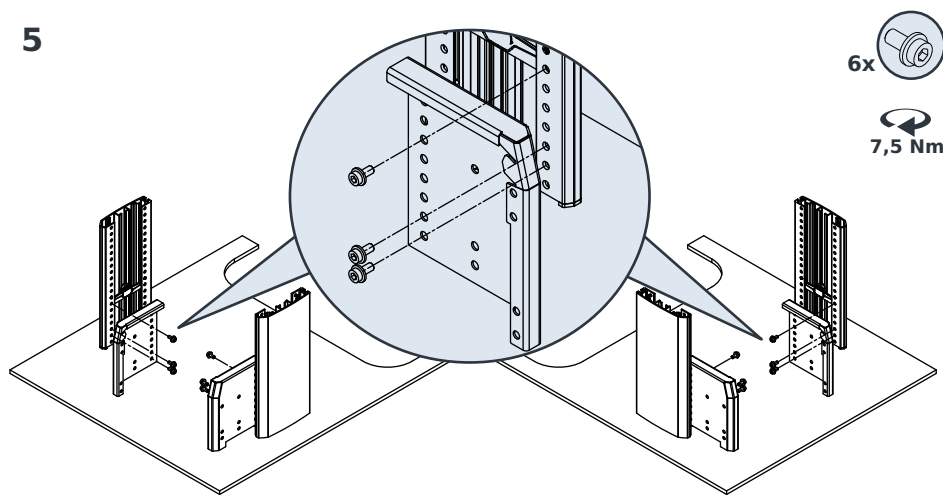

6

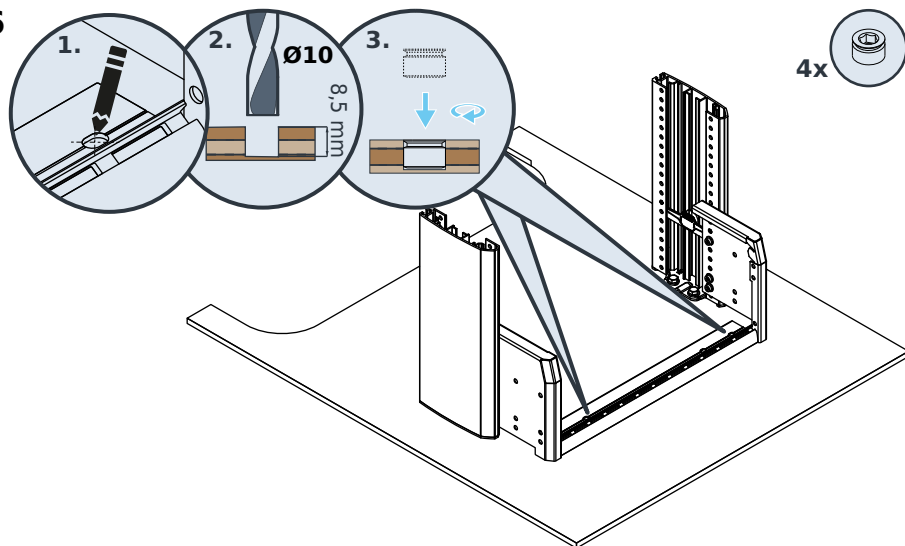

Floor flap with floor lashing rail

20-2

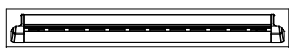

30-2



40-2



50-2



60-2



Floor flap with floor lashing rail

7

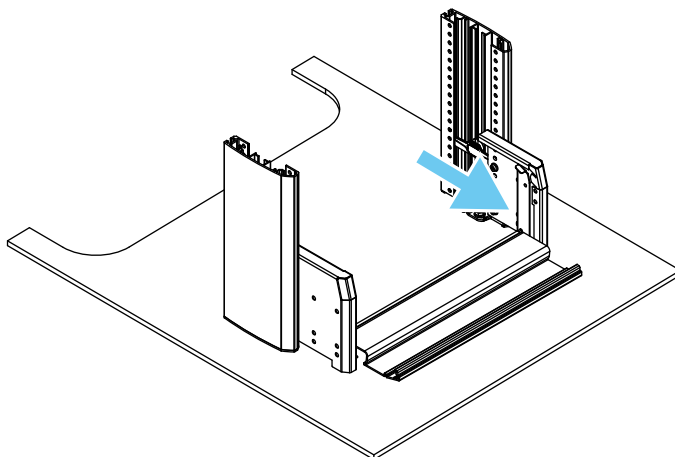

8

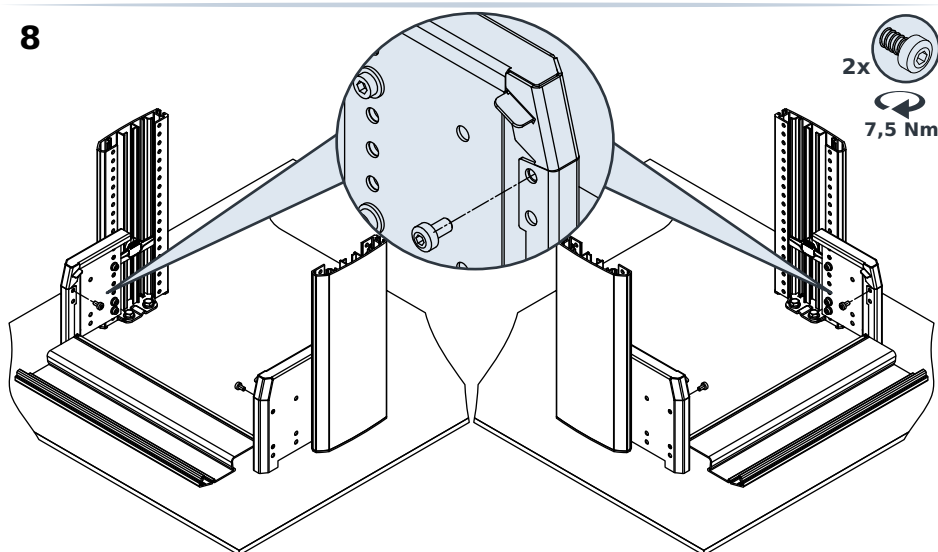

Floor flap with floor lashing rail

9

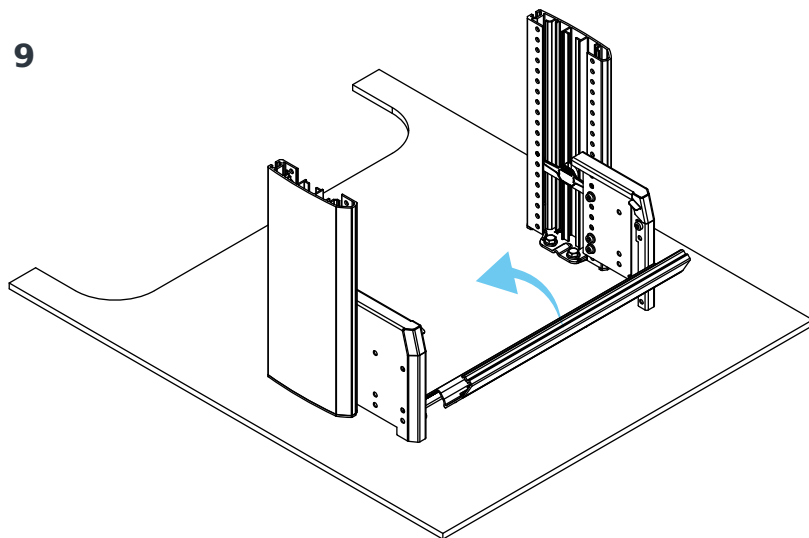

10

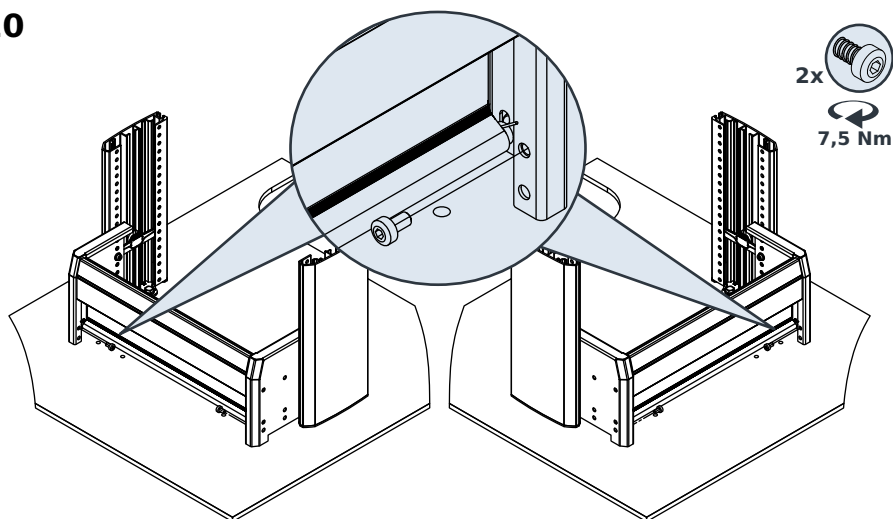

Floor flap with floor lashing rail

11

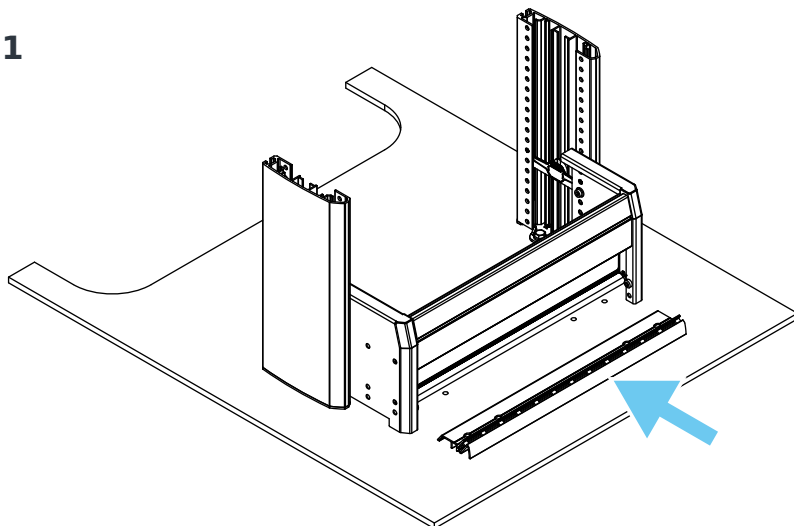

12

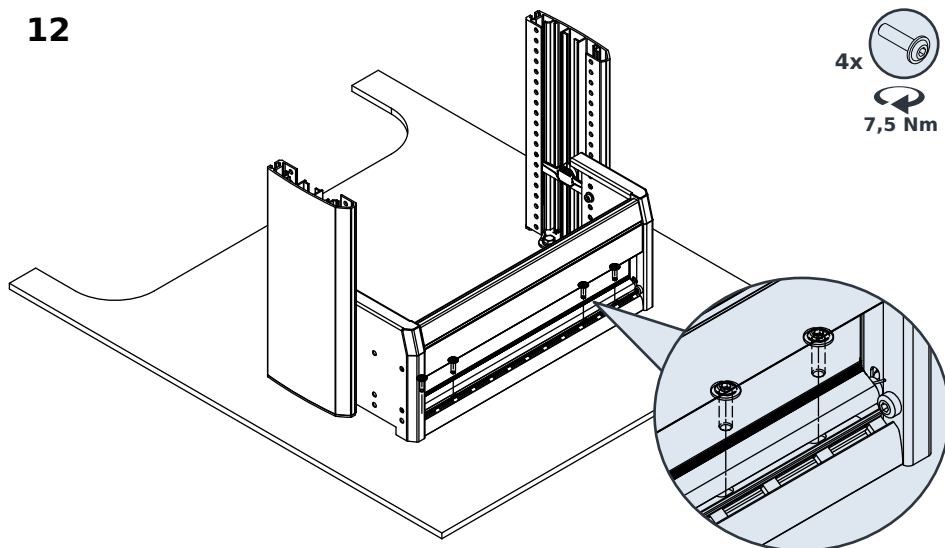

Floor flap with floor lashing rail

13

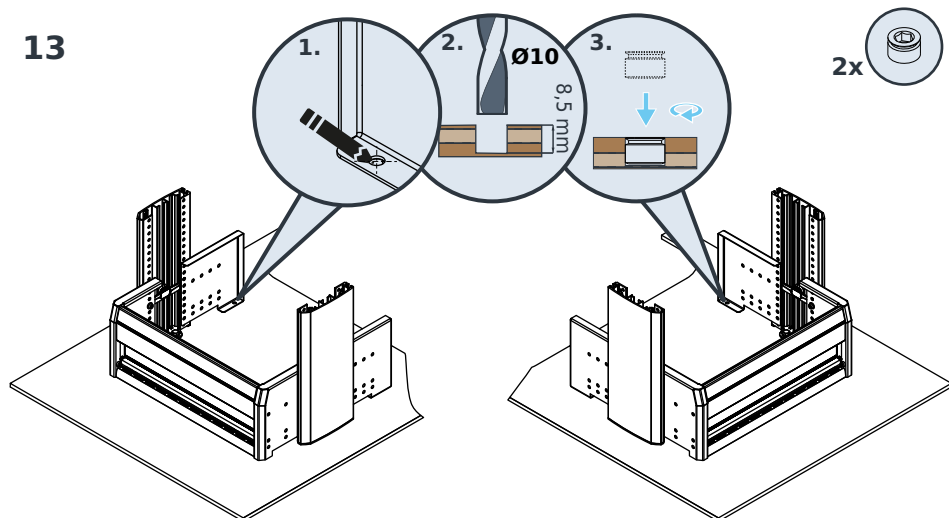

14

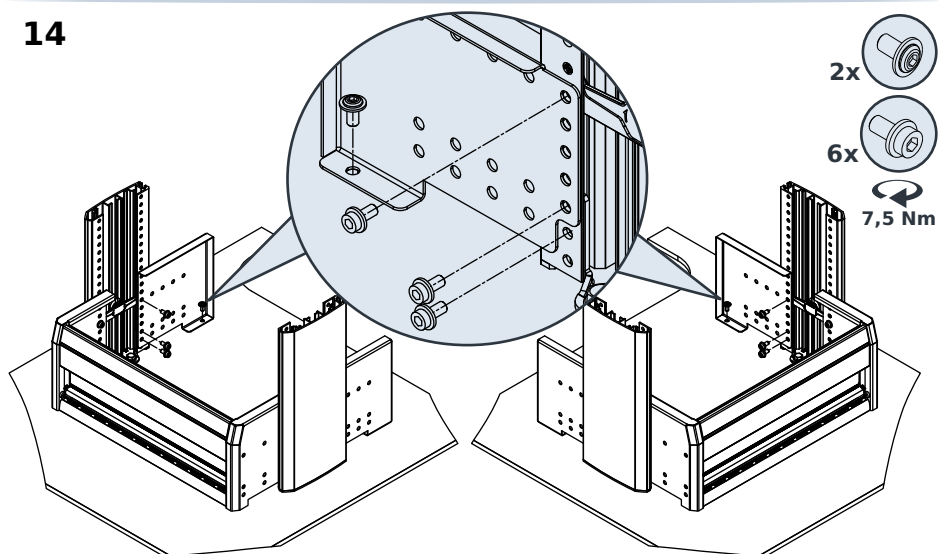

Universal cabinet

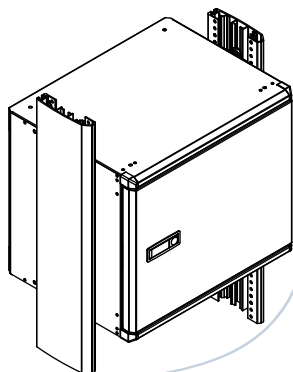

1

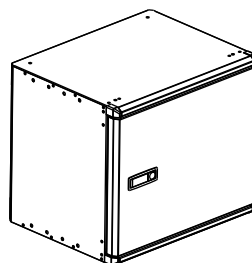

2

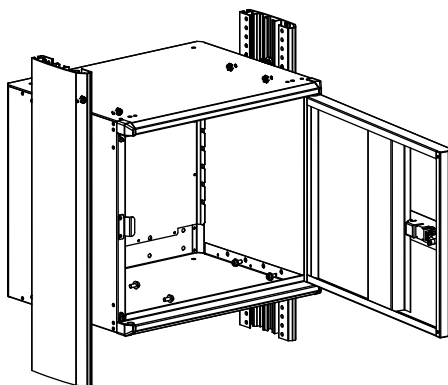
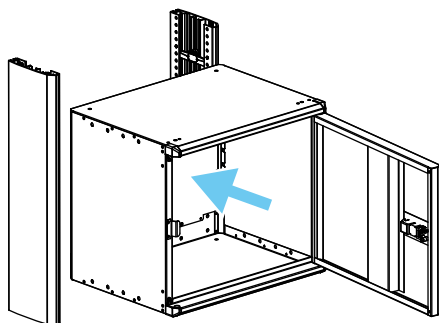

Hinged work bench

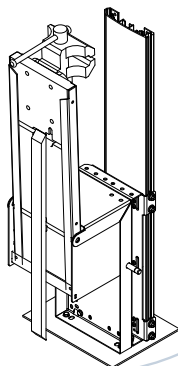

1

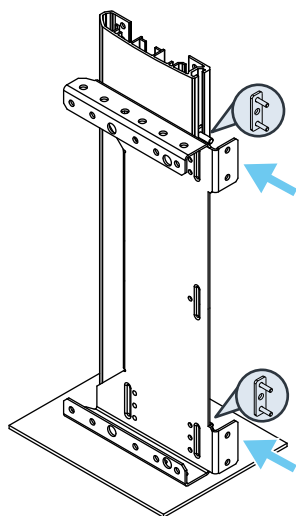

M6 x 20



M6



M6 12x8



M6 x 14

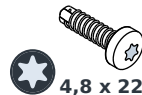

4,8 x 22

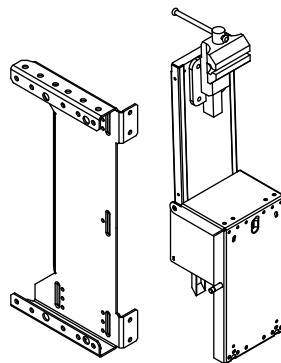

2

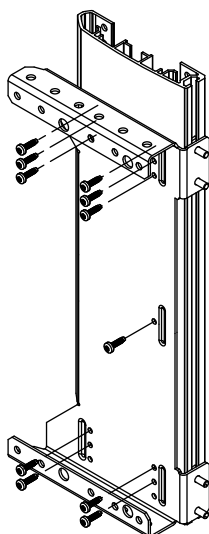

4,5 Nm



11x

3

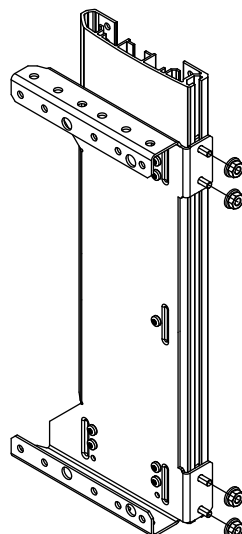

7,5 Nm



4x

Hinged work bench

min. 0 mm -
max. 63 mm

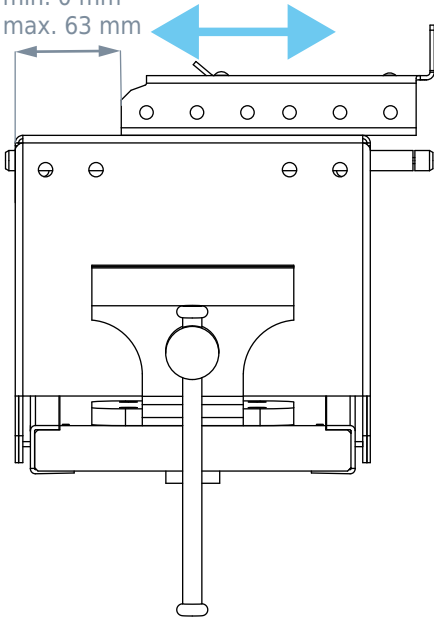

4

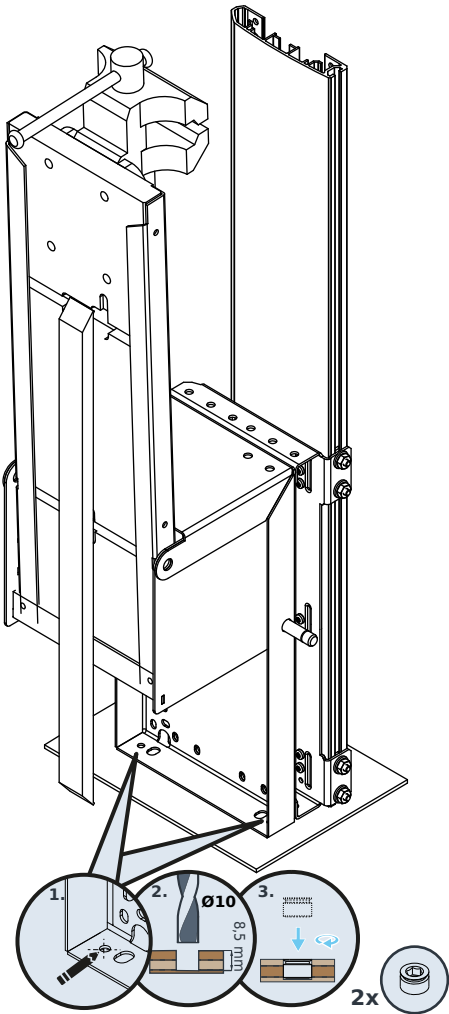

Hinged work bench

5

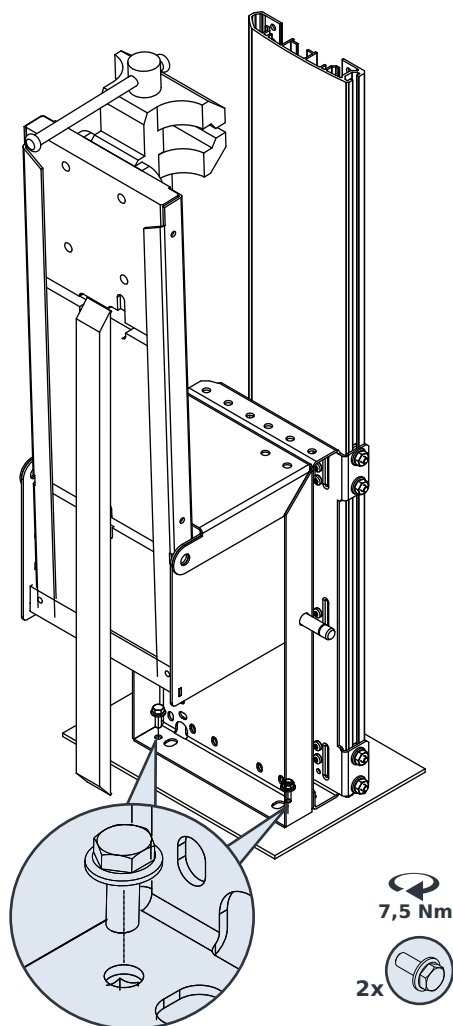

6

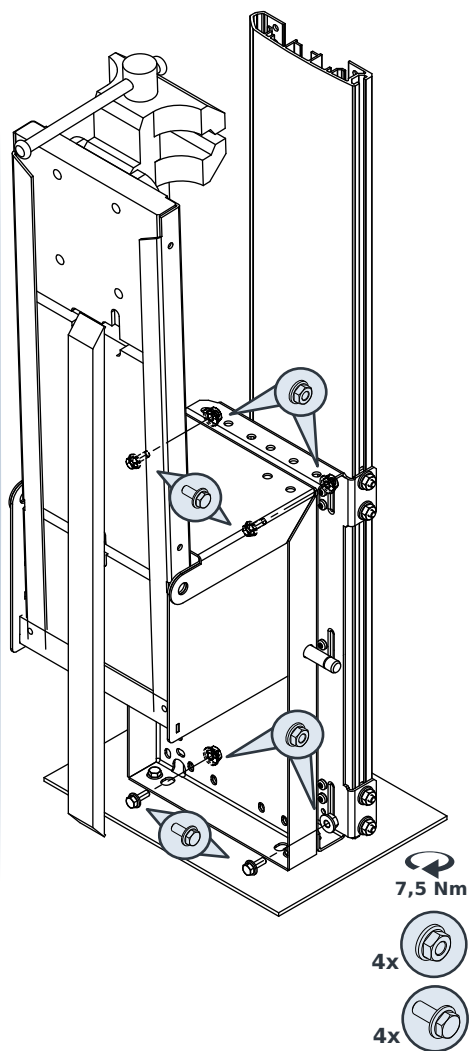

Long components tray

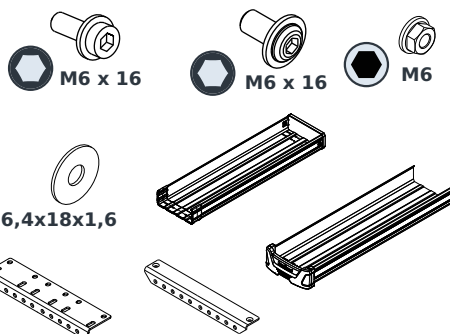
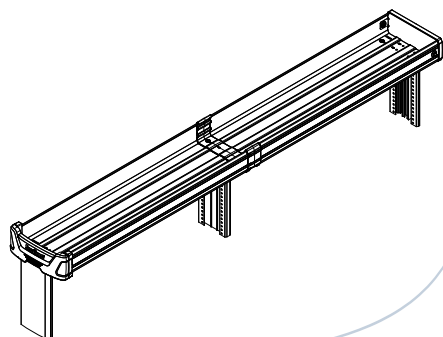

1

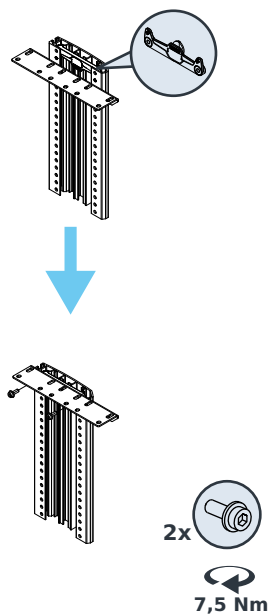
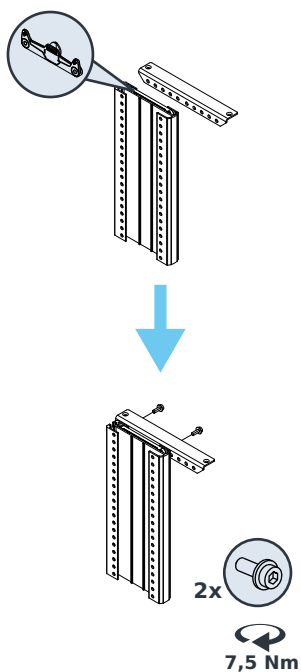
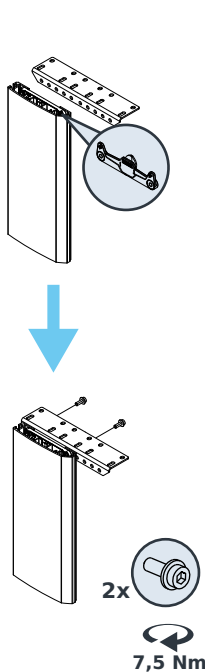

Long components tray

2

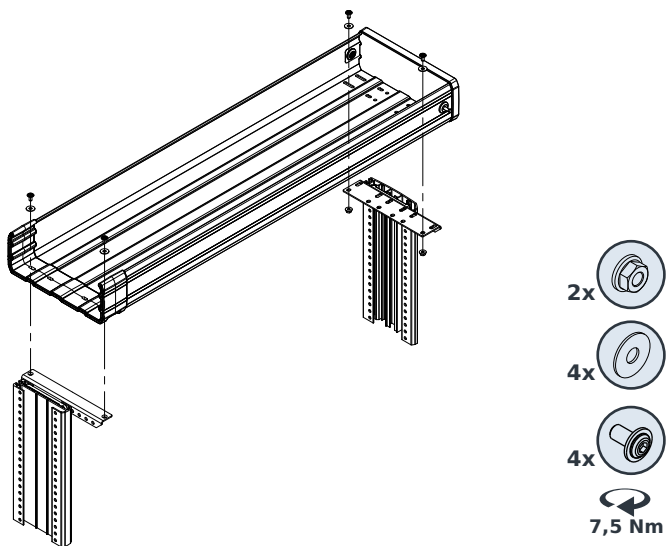

3

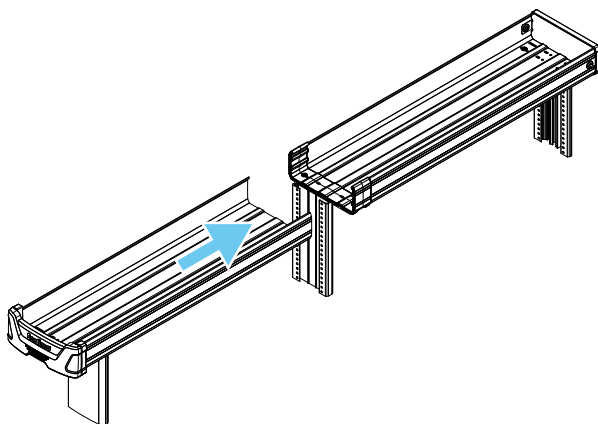

Long components tray

4

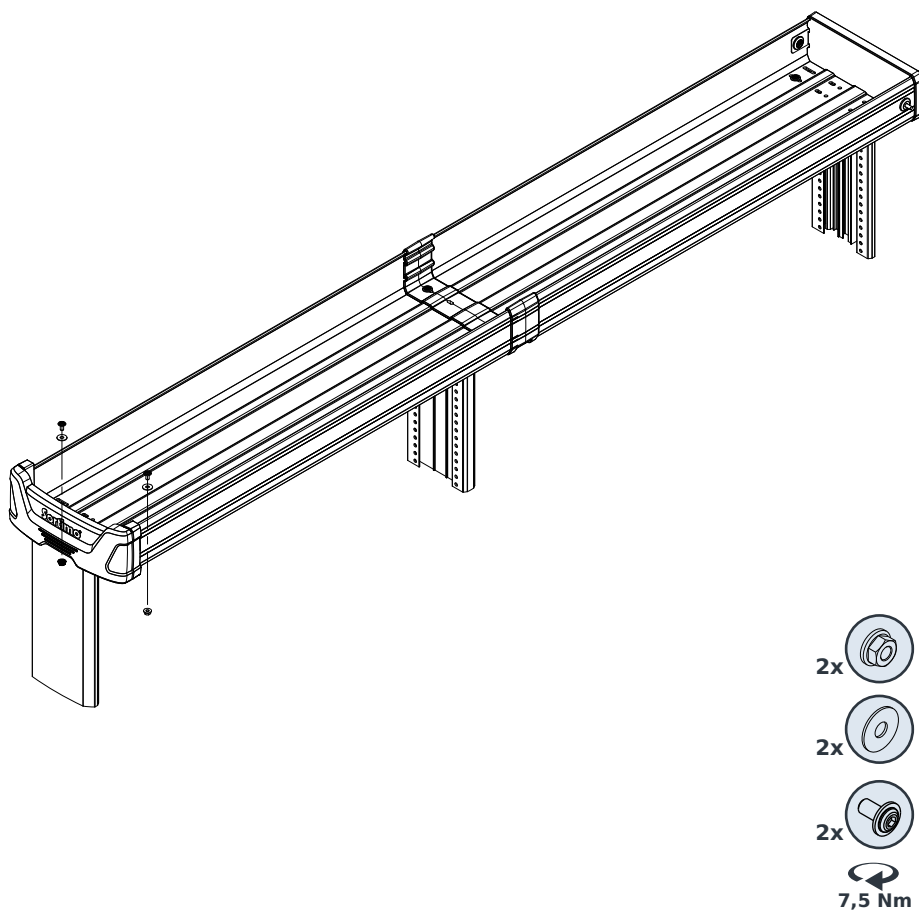

Case rail

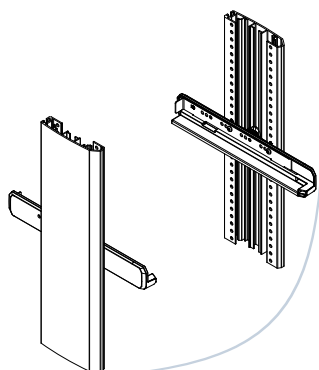

1

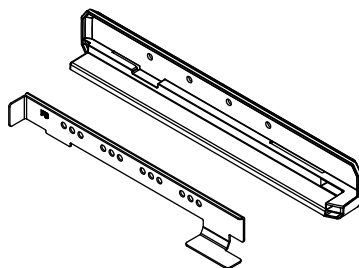

2

3

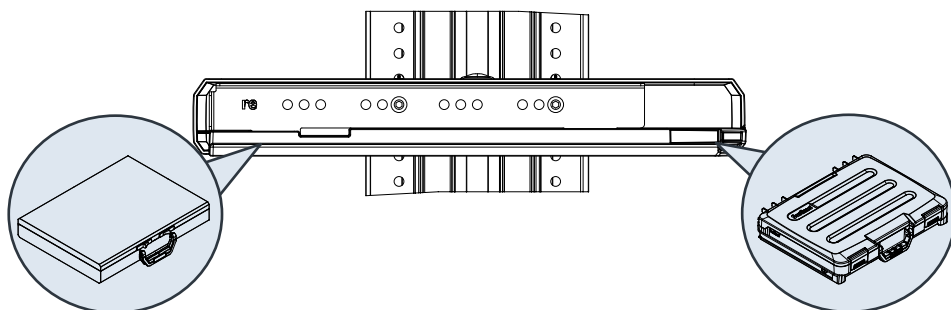
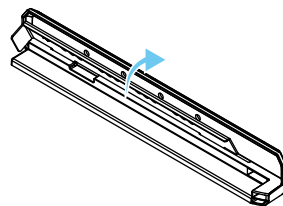
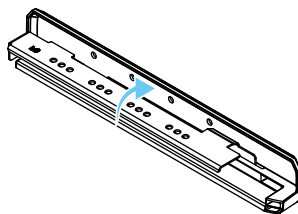
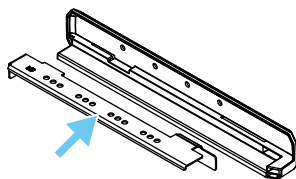

Case rail

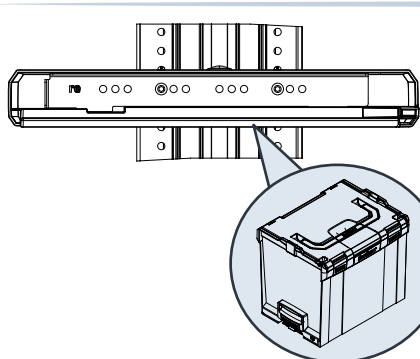
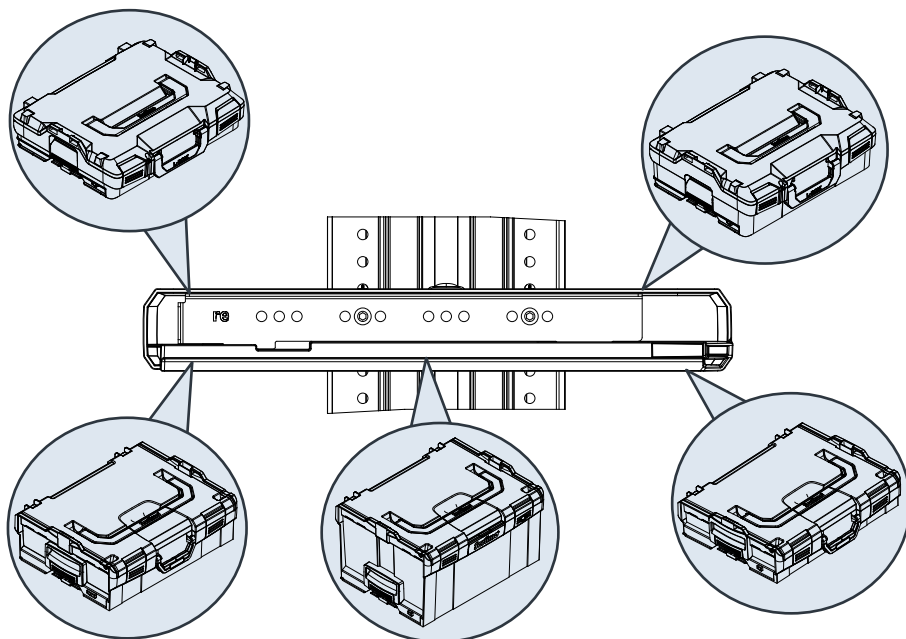

4

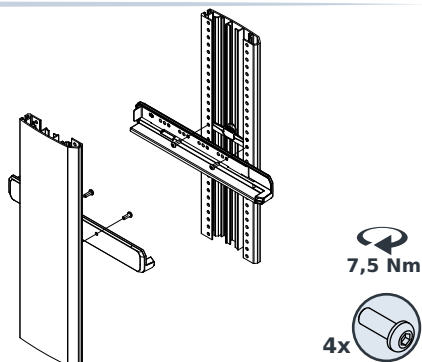

90° dual directional block



WARNING

Risk of injury due to missing vehicle components

Load can move from the rack system into the passenger compartment. This could result in serious or fatal injuries.

- ▶ Permissible installation.
 - ▷ Tested partition in accordance with DIN ISO 27956,
 - ▷ Partition with sliding door.
- ▶ If you have any questions, contact the manufacturer's Technical Support.
- ▶ **Impermissible** installation.
 - ▷ With partition grids
 - ▷ Without partition

Note: Certain elements are not included, depending on the configuration.

Scope of delivery

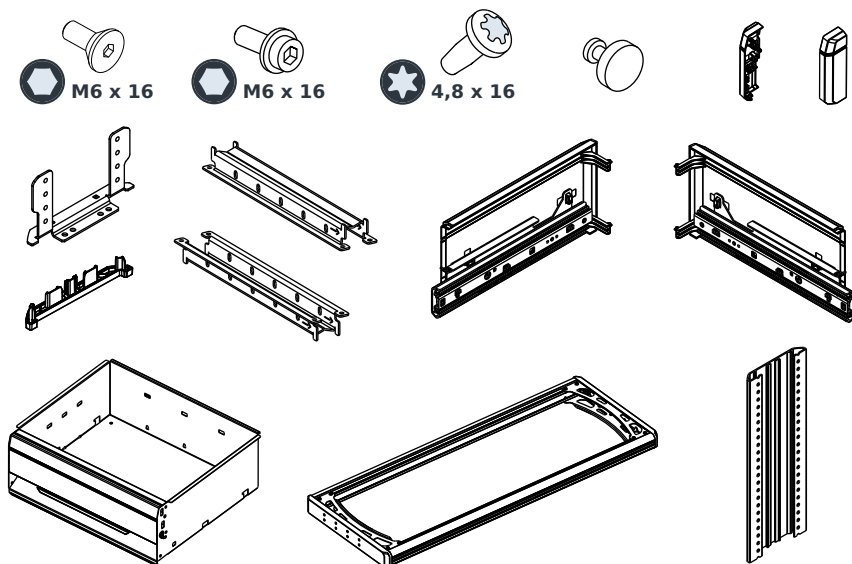

Step 1 — Installing the base frame

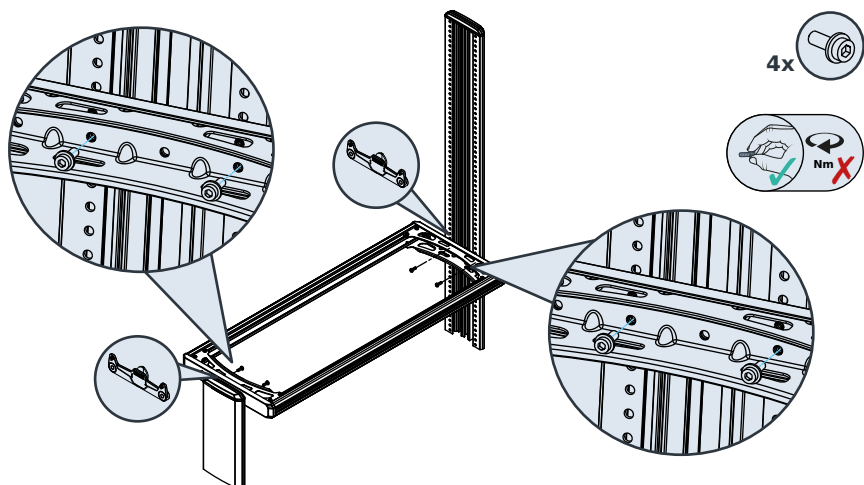

Step 2 — Installing the dual directional block profiles

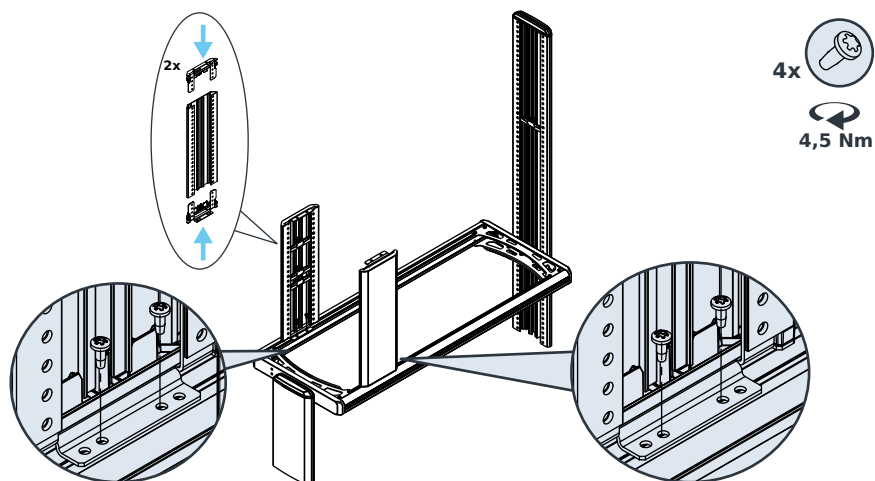

Step 3 — Installing the top frame

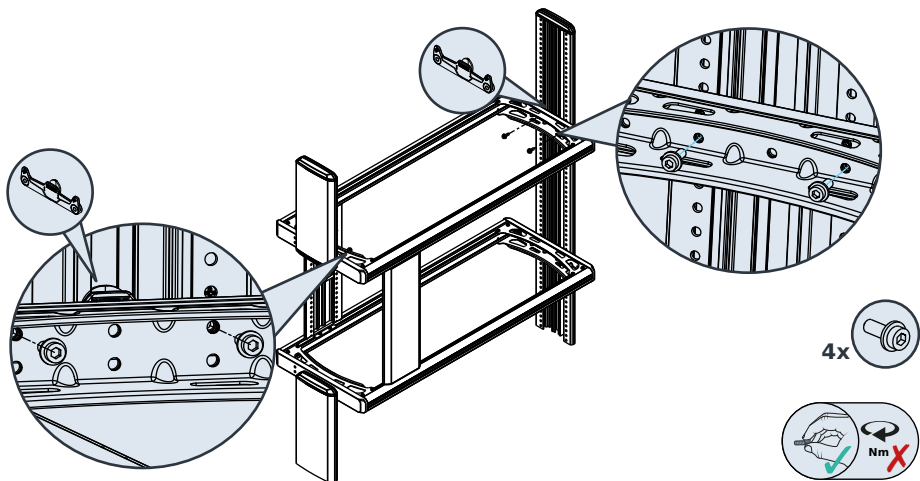

Step 4 — Preparing the intermediate profile

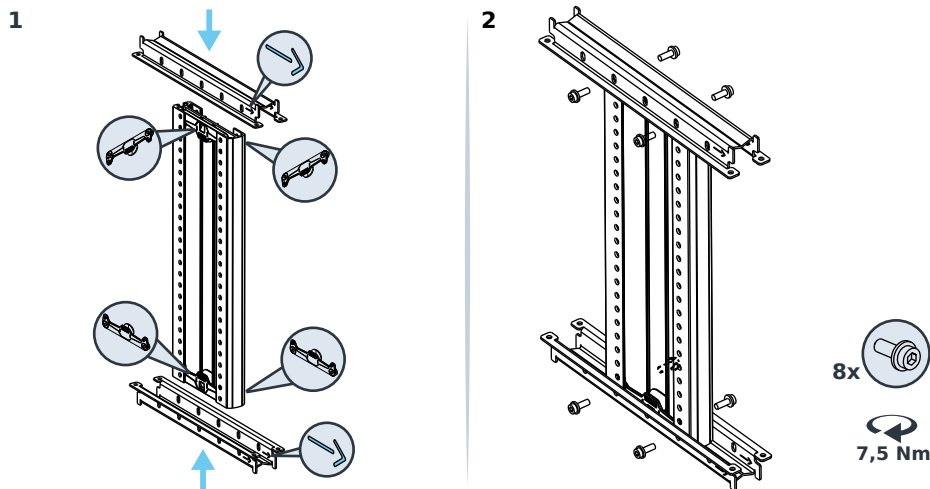

Step 5 — Installing the intermediate profile

1

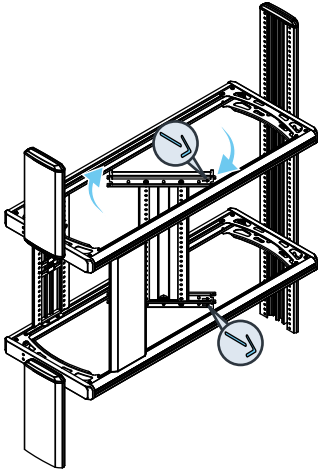

2

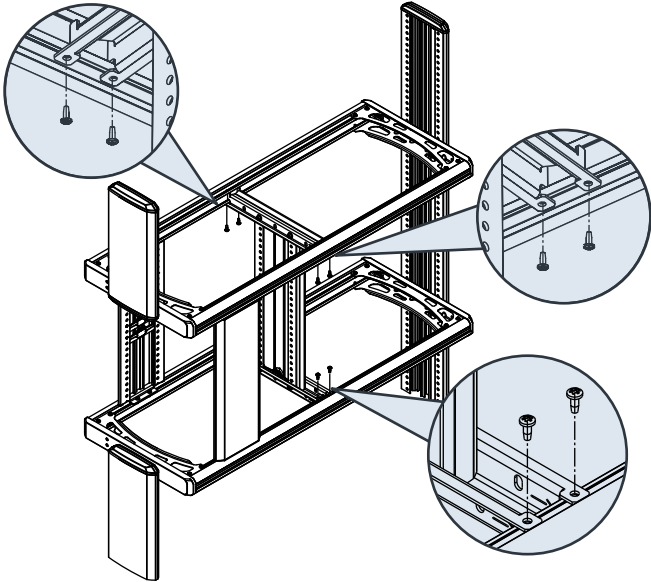

Step 6 — Installing drawers

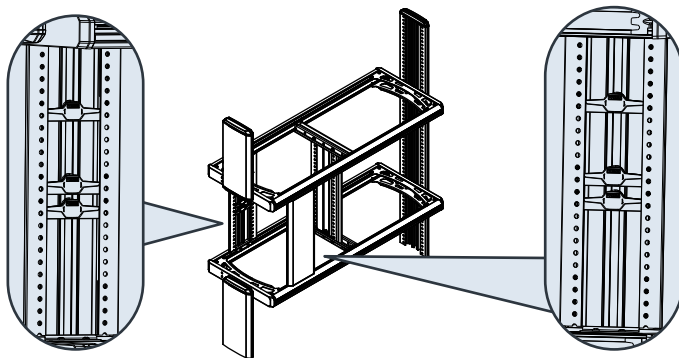

1

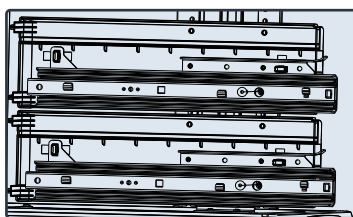

2

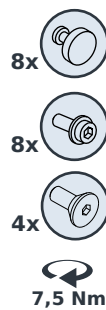
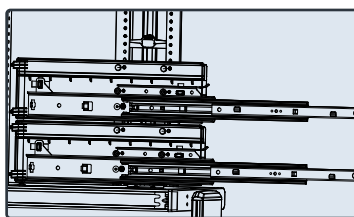
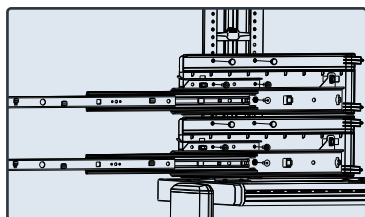

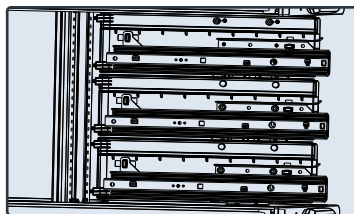
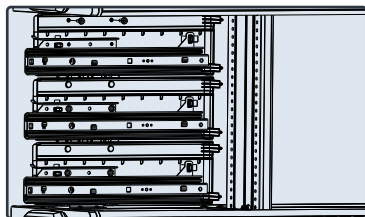
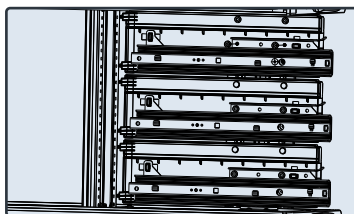
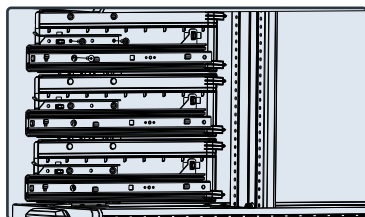
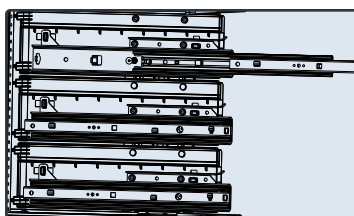
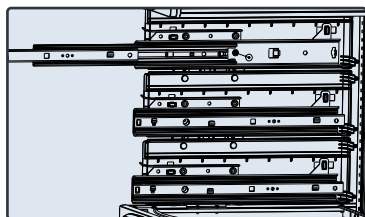
Step 6 – Installing drawers**3****4****5**

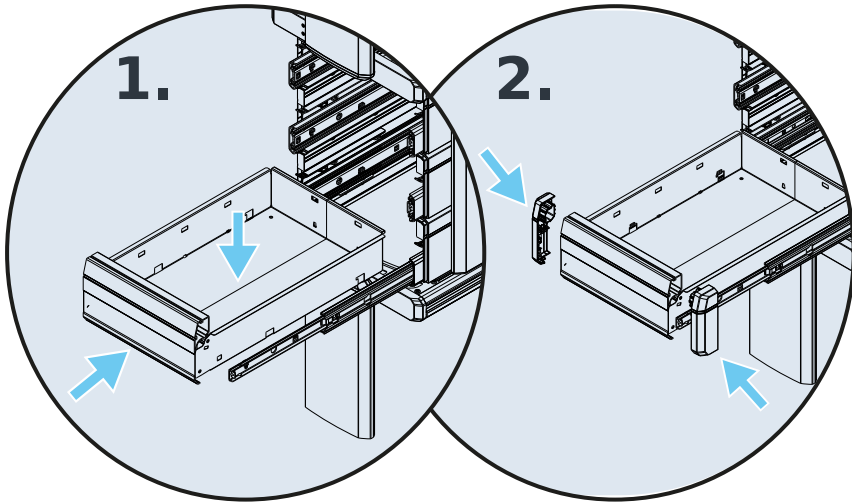
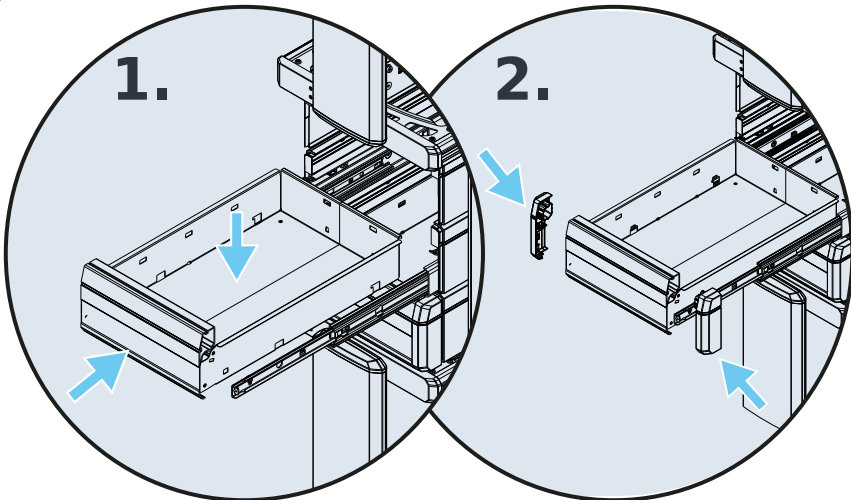
Step 6 — Installing drawers**6****7**

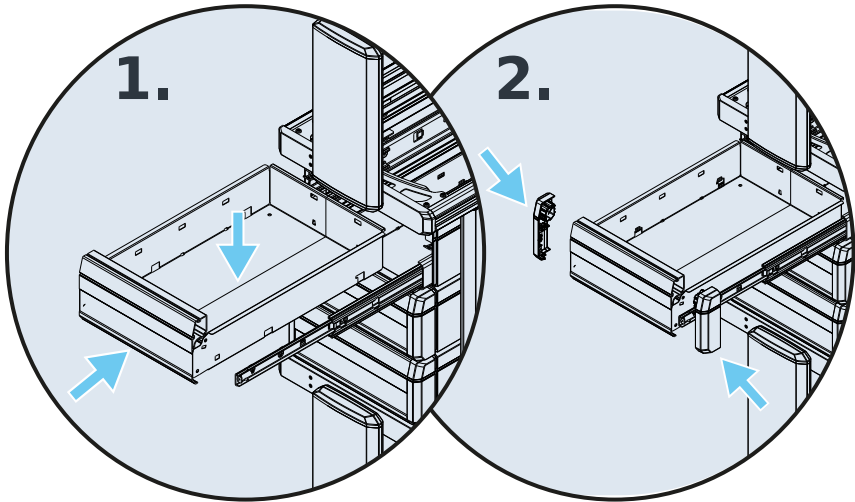
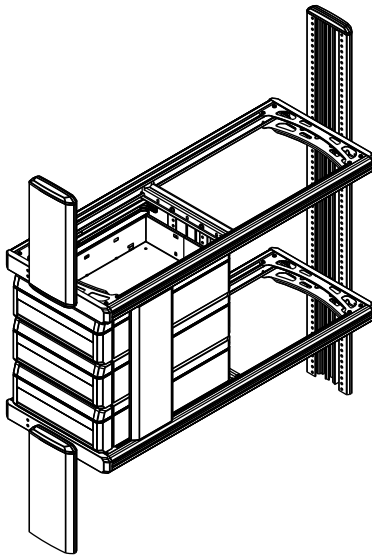
Step 6 — Installing drawers**8****9**

How to attach the racking

EcoFiX — What is it?

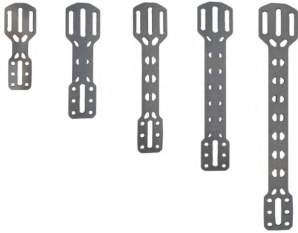

The block system is attached to the wall of the vehicle using EcoFiX brackets (EFI). There are different version of EFI available. The EFI bracket must be bent in compliance with the following strict rules to attach the block to the vehicle wall.



Rule

An EcoFiX can be bent at several places, however ...

- ... a max. of 45° at one point.
- ... only once at each point.
- ... the bending radius must be at least 4 mm.

Rule

EcoFiX can be twisted a max. of 90°.

Rule



Once installed, if there are EcoFix brackets in the area freely accessible to the user, then the edges of the EcoFix brackets need to be covered by an edge protection profile (Ref. No.: KU100720).

Attaching the EcoFiX bracket to the block system

Depending on the configuration, it can be attached to various elements of the block system.

- a) Directly on the profile,
- b) Directly on the shelf,
- c) Using a rear wall profile,
- d) Using UniFiX.

Directly on the profile

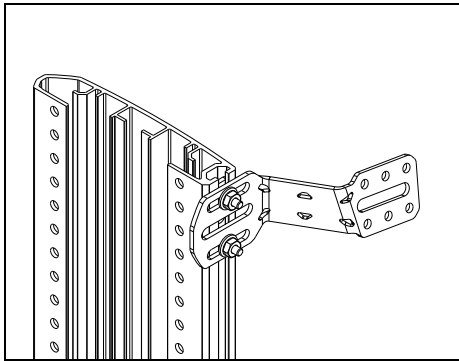

1

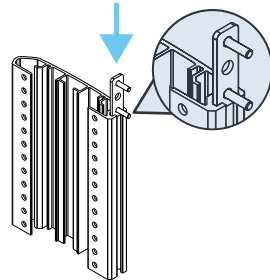

2



M6 x 20



M6

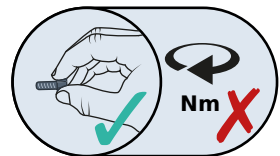
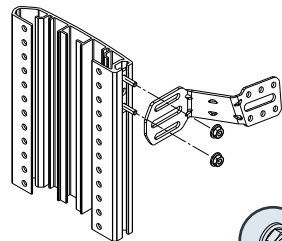

Directly on the shelf

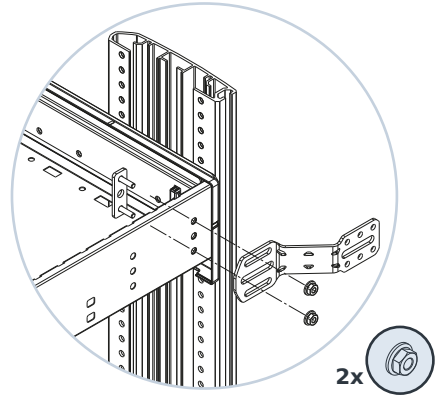
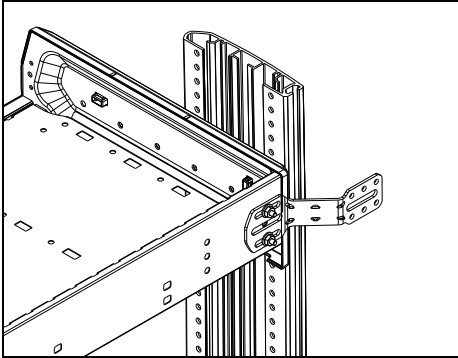

M6 x 20



M6

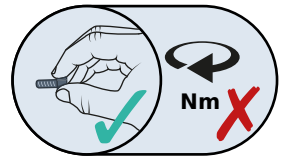

Using a rear wall profile

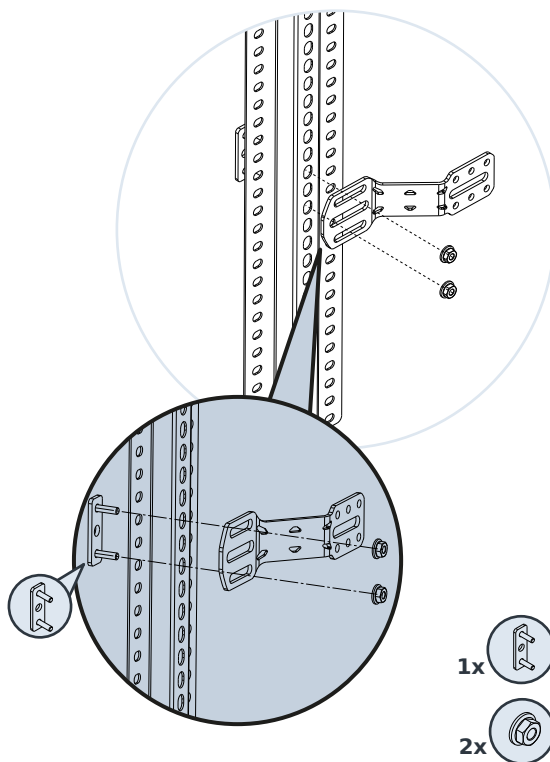
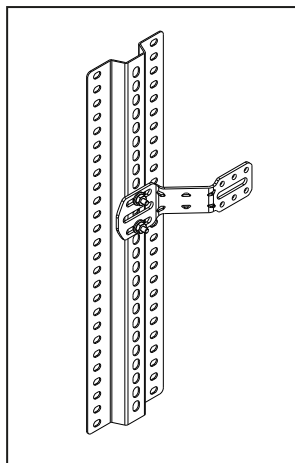

Using UniFiX

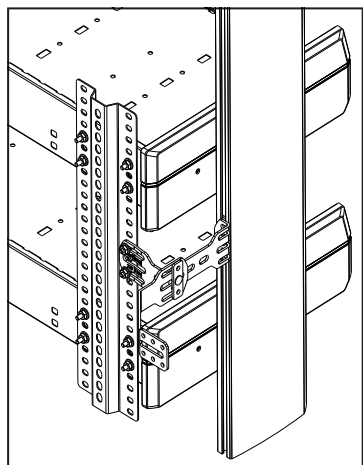

1

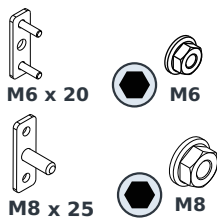
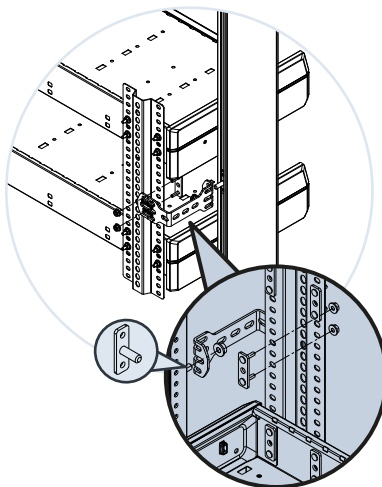

2

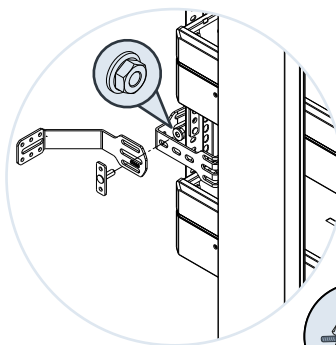

Connecting the rear wall profile

There are four options for fastening the rear wall profile to the van racking system.

- Fastening the rear wall profile to the shelving,
- Fastening the rear wall profile to the top of the frame,
- Fastening the rear wall profile to the bottom of the frame,
- Fastening the rear wall profile to the worktop shelf.

Fastening the rear wall profile to the shelving

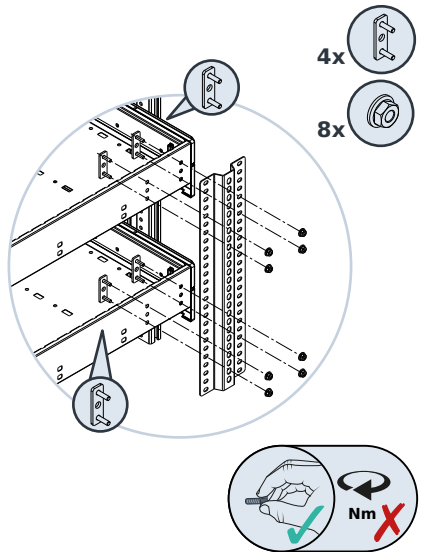
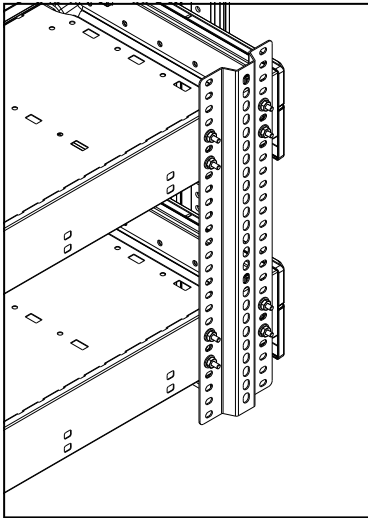

Fastening the rear wall profile to the top of the frame

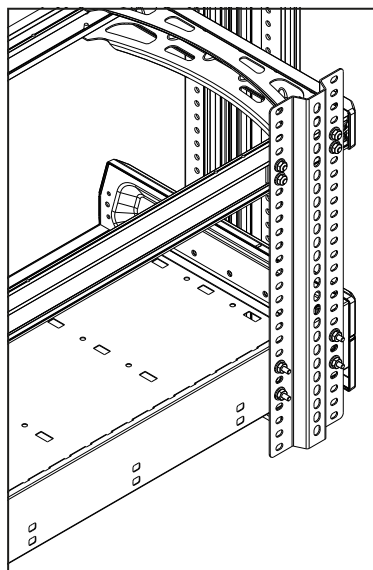

M6 x 20



M6 x 20



M6

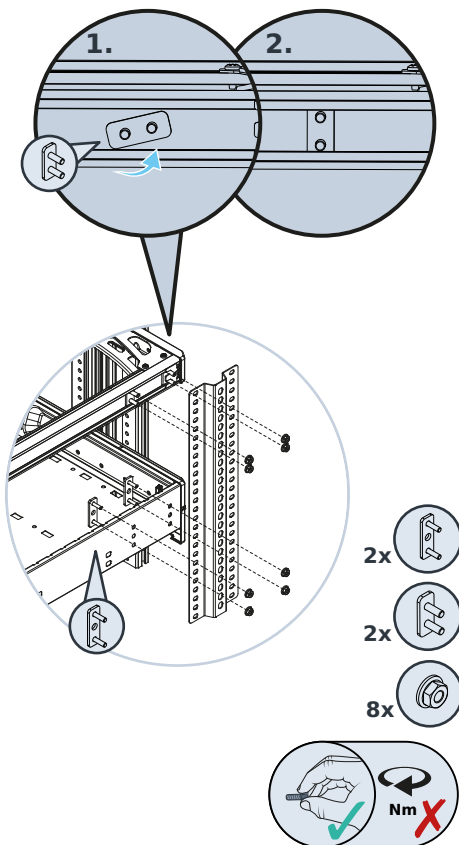

Fastening the rear wall profile to the bottom of the frame

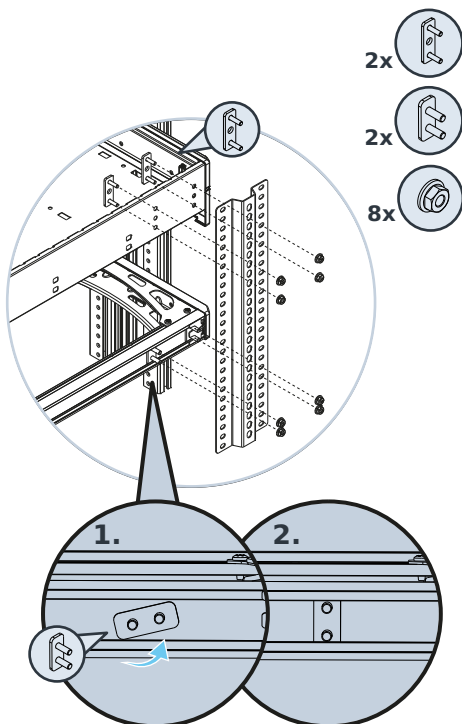
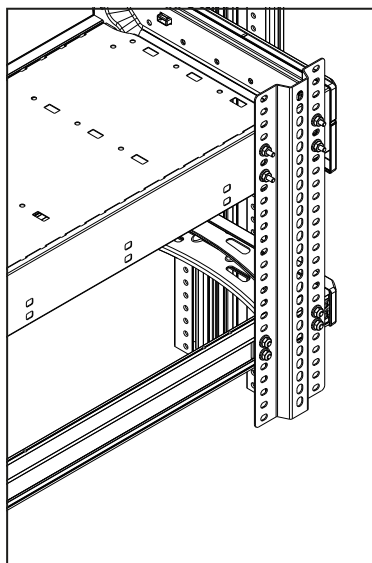

Fastening the rear wall profile to the worktop shelf

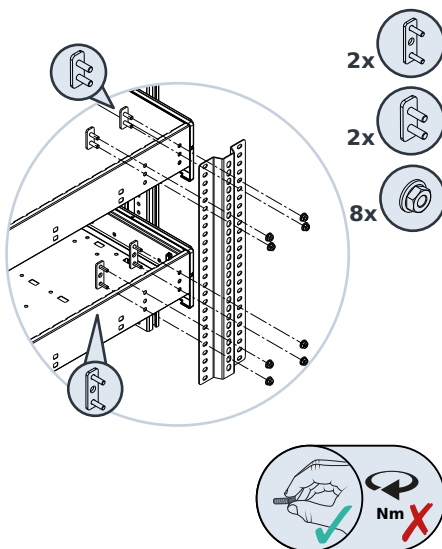
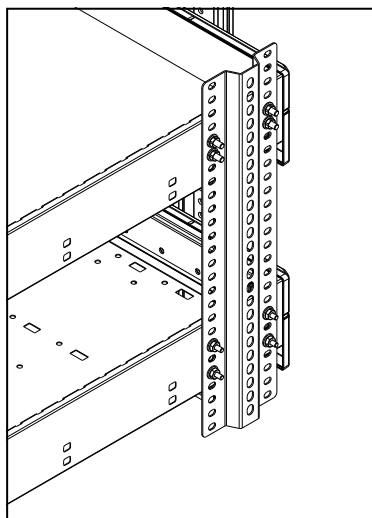

Extending the rear wall profile

Depending on the configuration, the rear wall profile can be extended in different ways.

- Rear wall profile connector
- Rear wall profile depth adapter

Rear wall profile connector

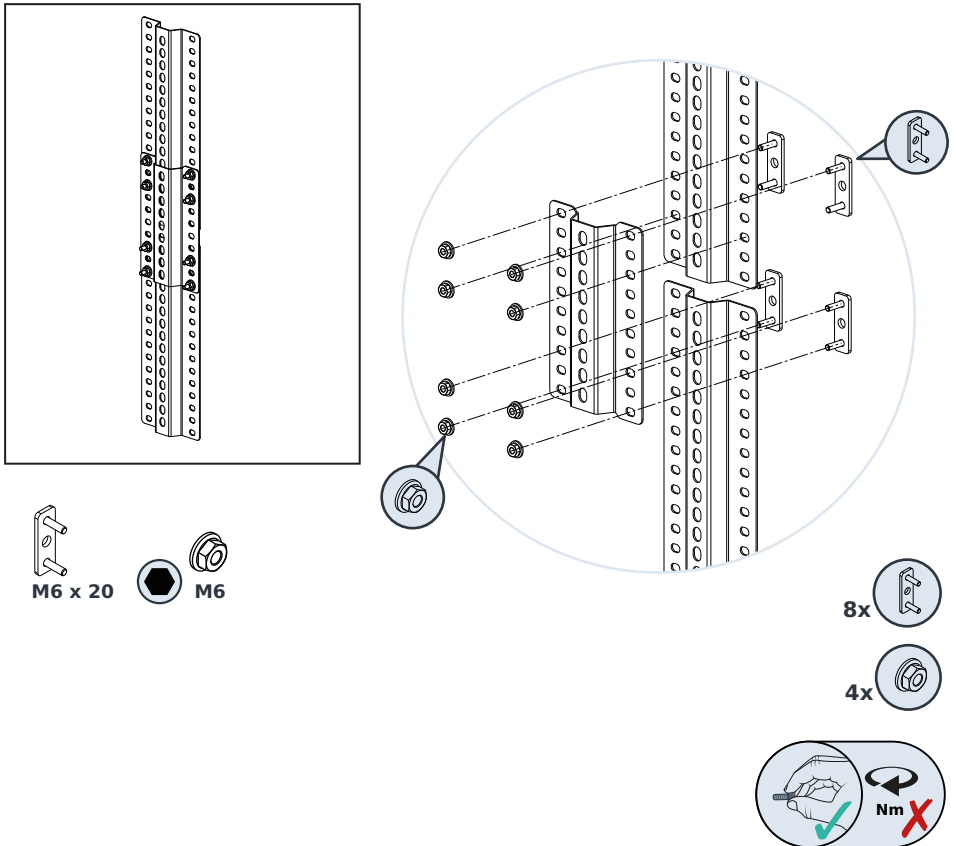

Rear wall profile depth adapter

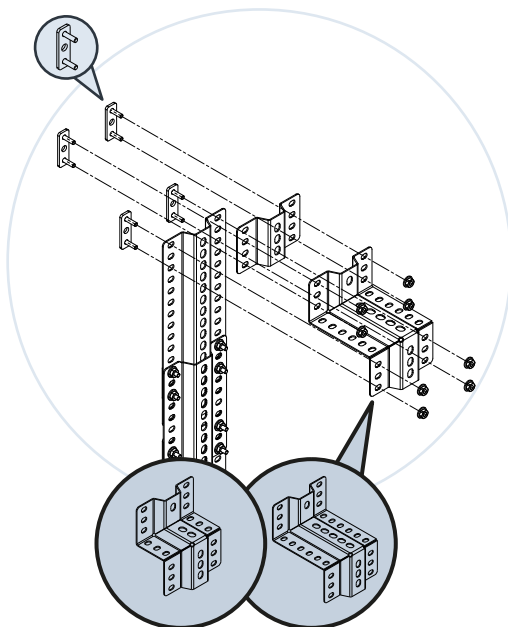
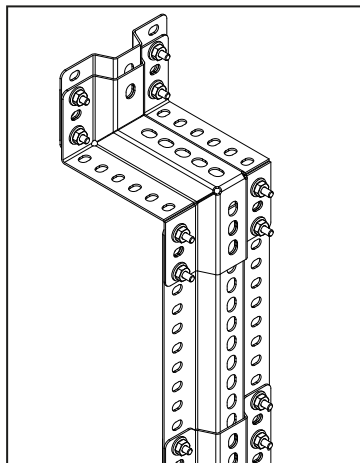

Attaching EcoFiX brackets to the vehicle wall

There are two options for attaching the EFI to the wall of the vehicle.

- a) Blind rivet nuts,
- b) Fastening plates.

Rule If possible, attaching the EcoFiX bracket using a fastening plate is preferable to attaching it with blind rivet nuts.

Blind rivet nut

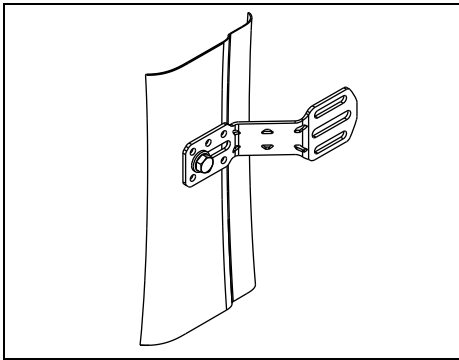

1

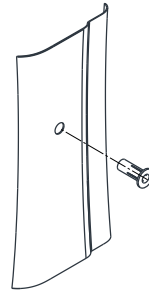

2

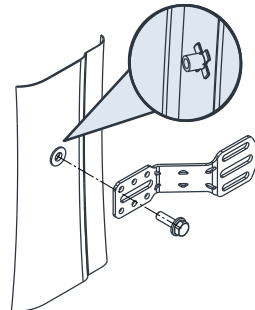

M8 x 29

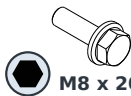

M8 x 20

ATTENTION

Damage to vehicle due to drilling

- Note the warning in the Chapter "Attaching the block".

Note:

- Requires a Ø 11.2 mm hole.
- Use the existing hole on the chassis (original hole) or drill a new hole.

Fastening plate

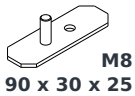
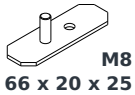
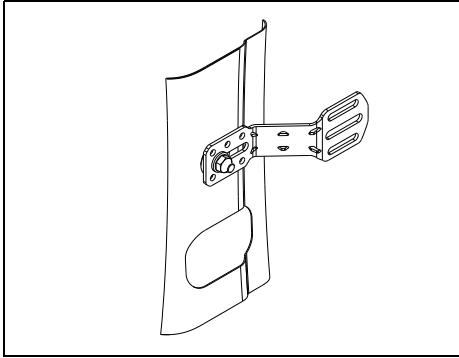

1

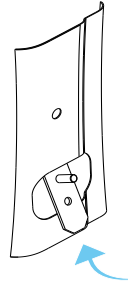

2

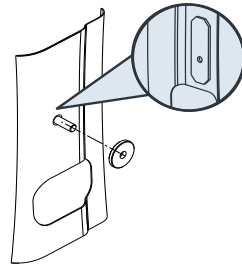

3

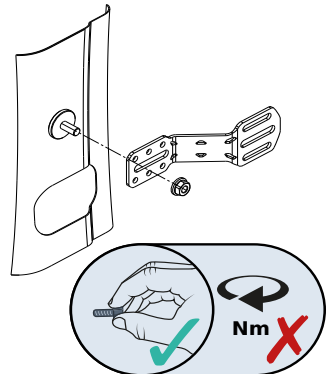
**ATTENTION****Damage to vehicle due to drilling**

- Note the warning in the Chapter “Attaching the block”.

Note:

- This fastening requires sufficient hollow space behind the load-bearing elements. The fastening plates cannot be positioned without this hollow space.
- Requires a Ø 8.5 mm hole.
- Use the existing hole on the chassis (original hole) or drill a new hole.

Determining the number and position

An EcoFiX bracket is attached in either a pull or push direction. A block system needs to be secured in place in both directions. Up to three areas are defined depending on the grid height of the block system. Rules are defined below for these areas.

Rule Position the EFI as high as possible in each area.

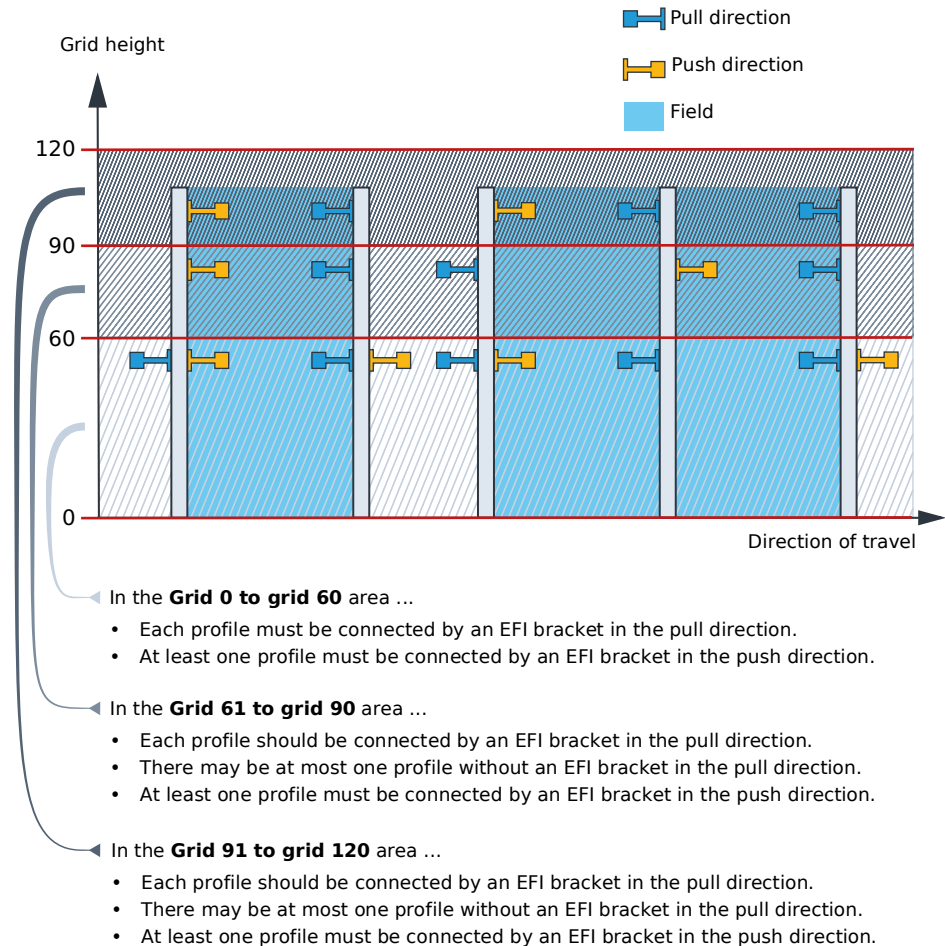

Attaching the block

ATTENTION

Damage to vehicle due to drilling

Components within the vehicle wall could be damaged.

- ▶ Pay attention to components within the vehicle wall such as lines, etc.
- ▶ Use a drill sleeve.
- ▶ Pay attention to the manufacturer's set-up guidelines.
- ▶ Only attach to suitable locations.
 - ▷ Stable pillars,
 - ▷ Stable longitudinal beams.
- ▶ Do **not** attach to an unstable intermediate support or wheel housing.

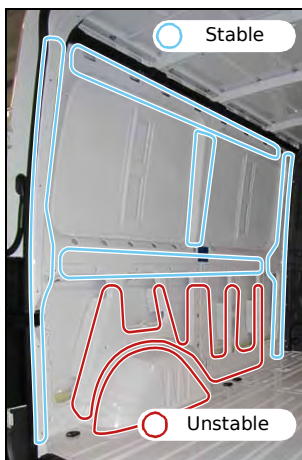

Step 1 — Preparing the EcoFIX brackets

- ▶ Find a suitable position.
- ▶ Use a pen to mark the positions on the block system and the vehicle wall.
- ▶ Bend the EcoFIX.
- ▶ Repeat these steps until all EcoFIX brackets have been prepared for use.

Step 2 — Preparing the vehicle wall

- ▶ Prepare the attachment points on the vehicle wall.
 - ▶ Repeat these steps until all the attachment points have been prepared.
-
- ▶ If a side wall cladding is to be installed in the vehicle, the attachment points should be transferred to the side wall cladding.
 - ▶ Install the prepared side wall cladding in the vehicle.

Step 3 — Attaching the block system to the vehicle wall

- ▶ Attach the EcoFIX brackets to the block and to the vehicle wall.
-
- ▶ Align the block system.
-
- ▶ Tighten the screw fixings to the following torques.

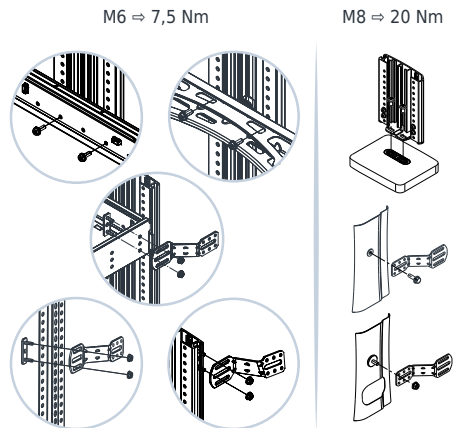

Step 4 — Attaching safety markings

- Attach safety markings to the divider in the cargo area so that they are clearly visible.

Note: KU1014727

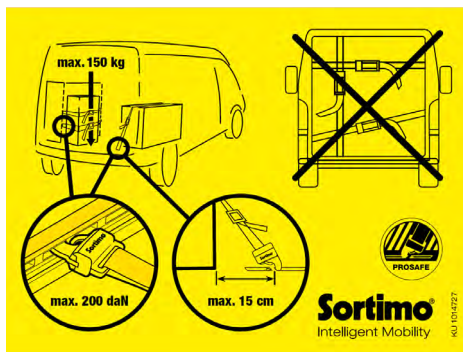

Mounting accessories

Plastic slide at top

6000011582
6000011583
6000011584

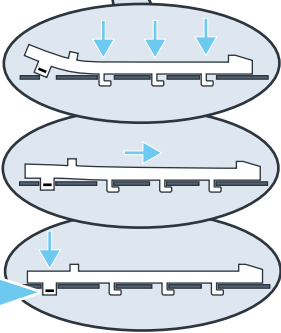
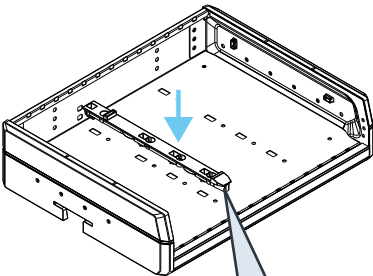
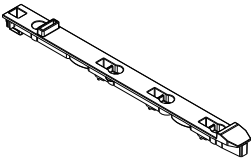
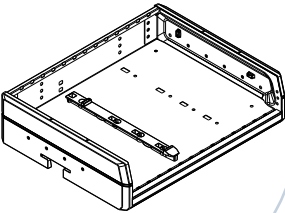

Plastic slide at bottom

A 1000012239
1000012241

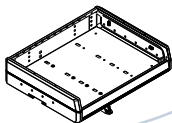

B 1000012238
1000012240

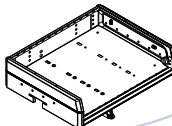

6 x 18



6 x 38

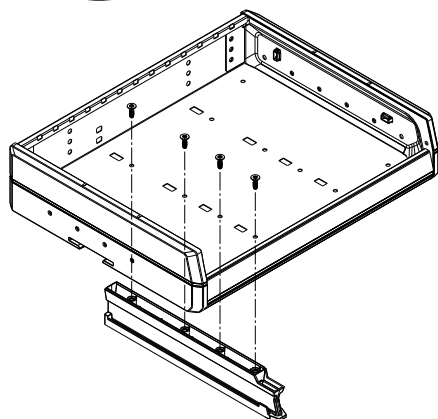
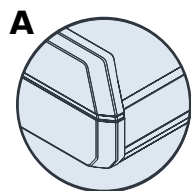
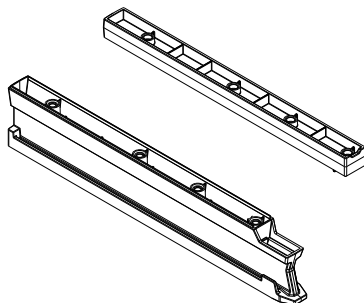

7,0 Nm

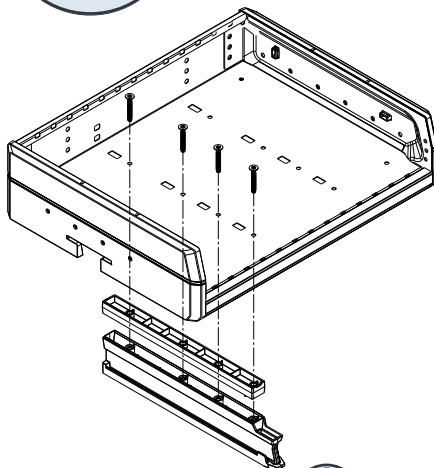
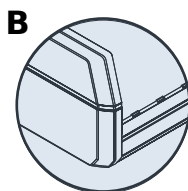

7,0 Nm

Plastic slide at bottom 04-0 FB03

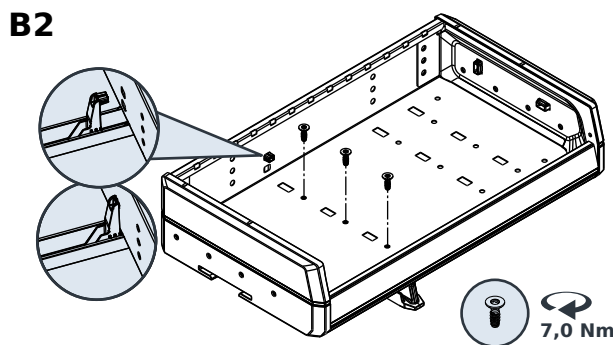
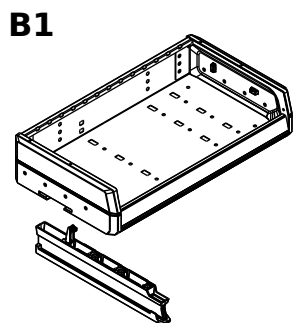
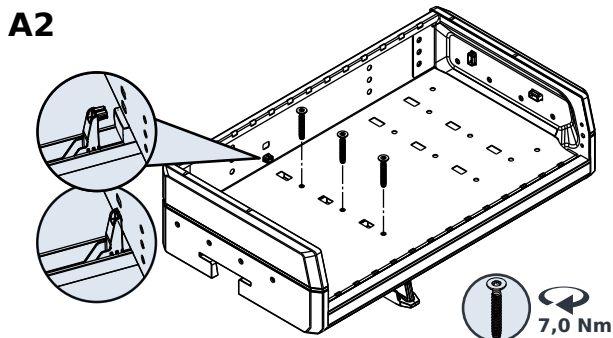
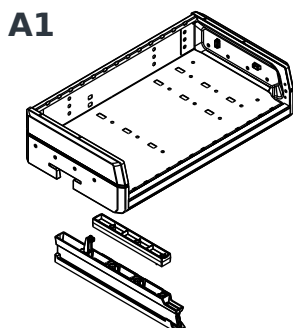
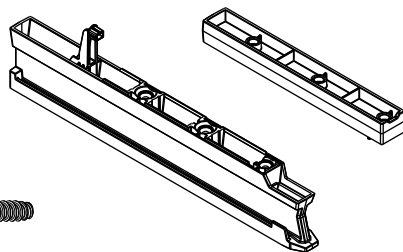
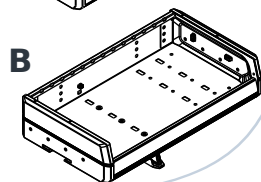
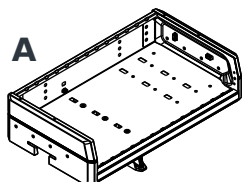

Plastic slide at bottom and top

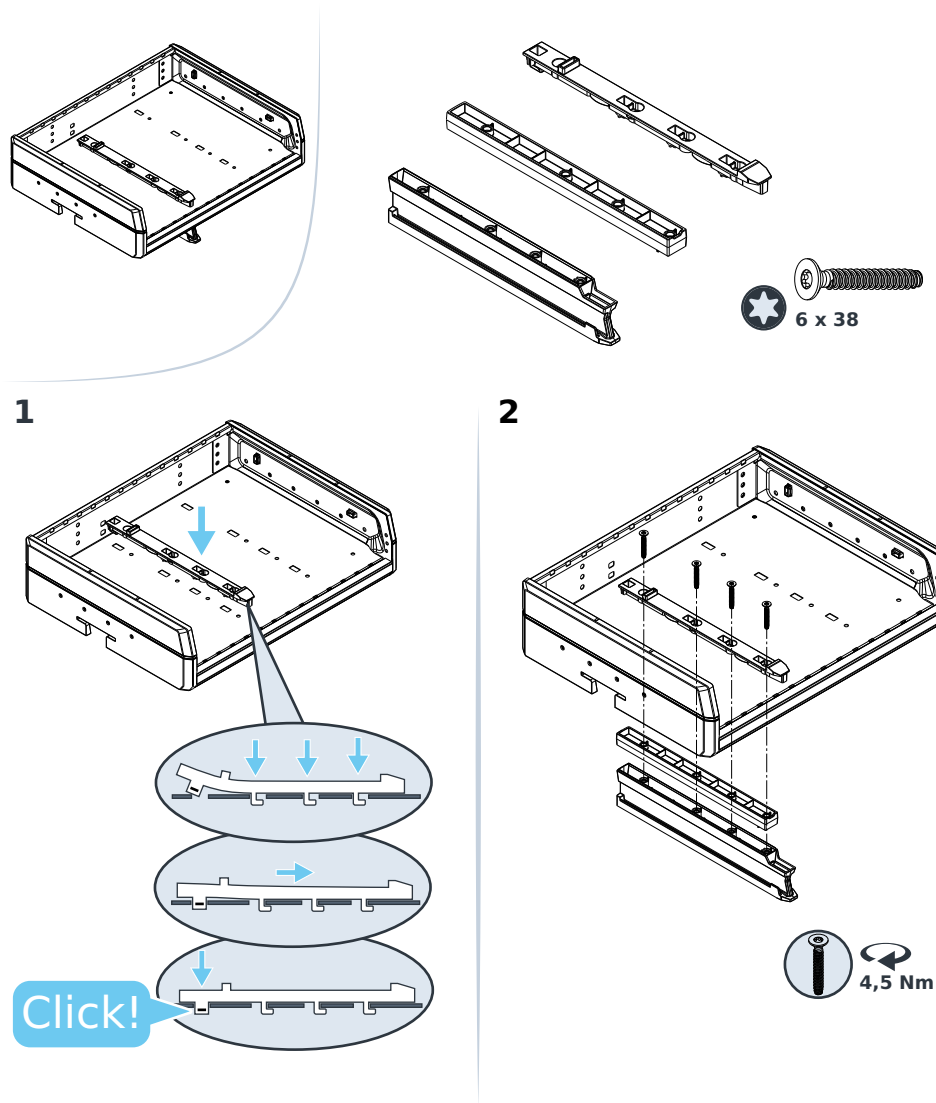

Divider for shelf

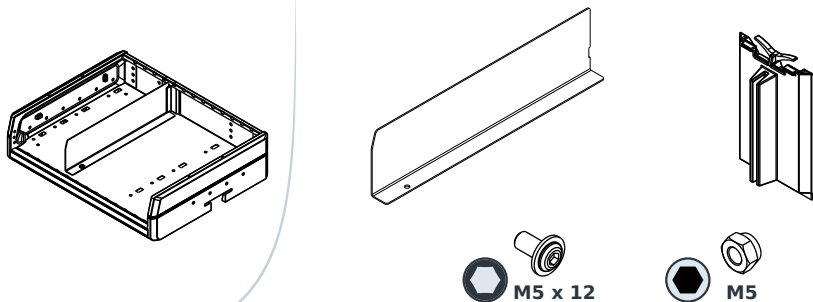

1

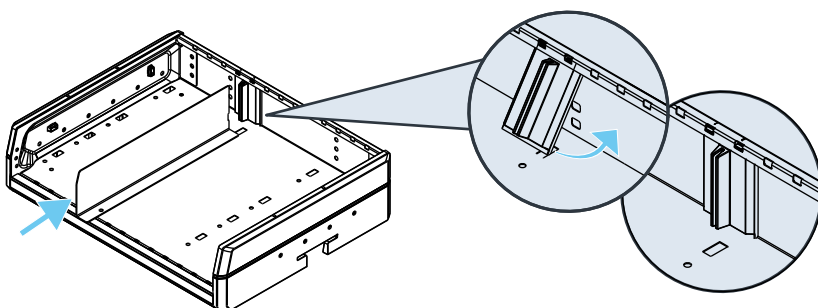

2

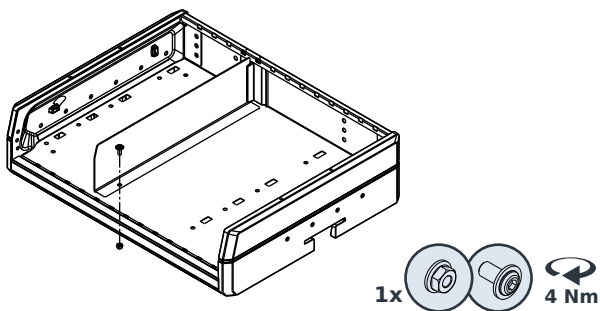

Divider for shelf with border

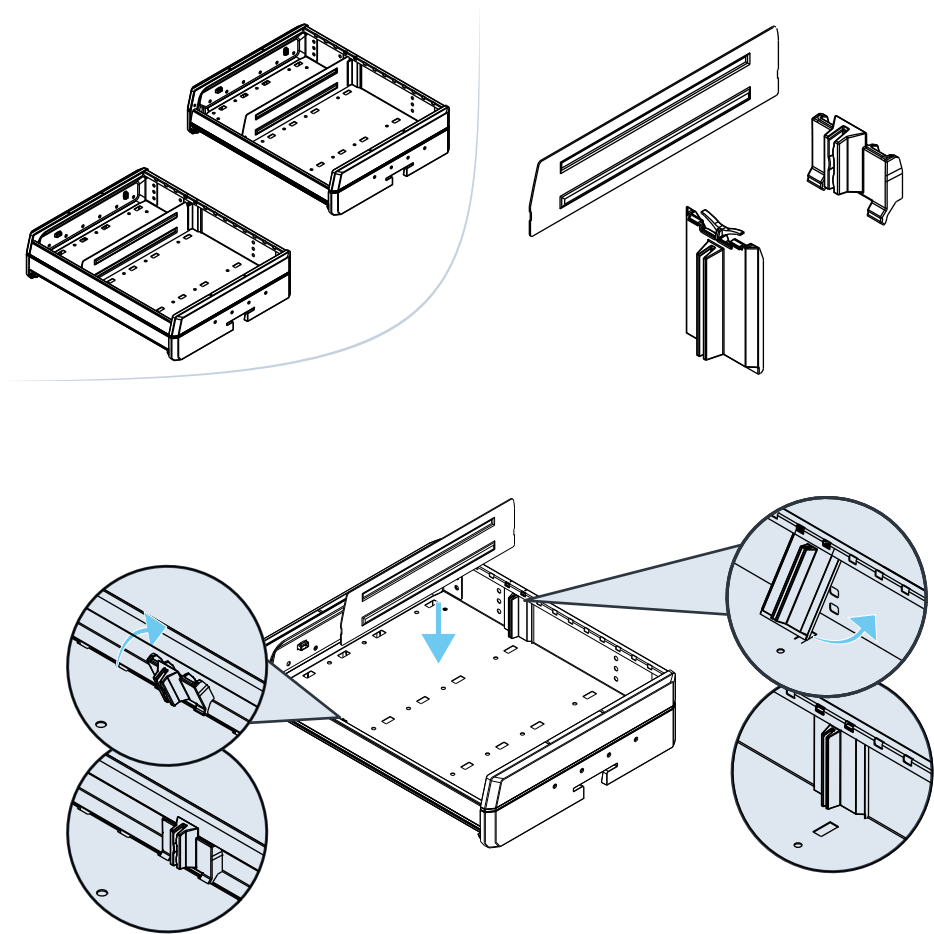

Shelf for universal cabinet

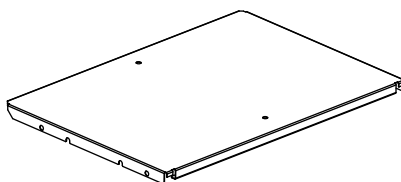
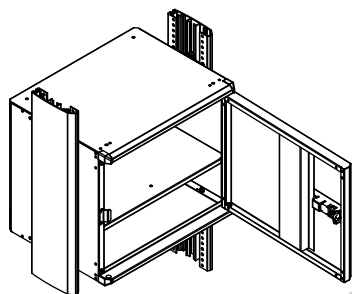

1

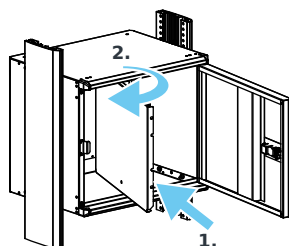

2

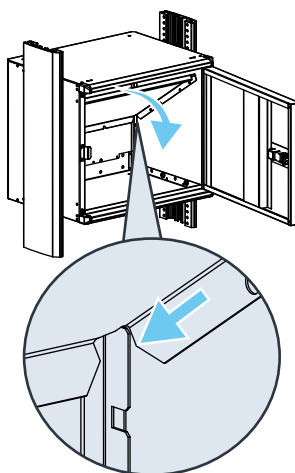

3

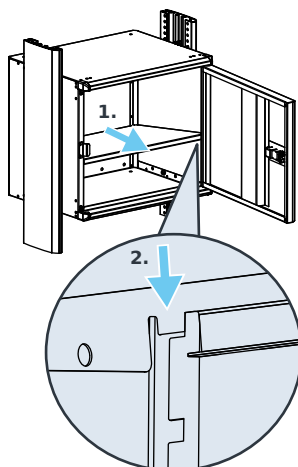

Worktop shelf

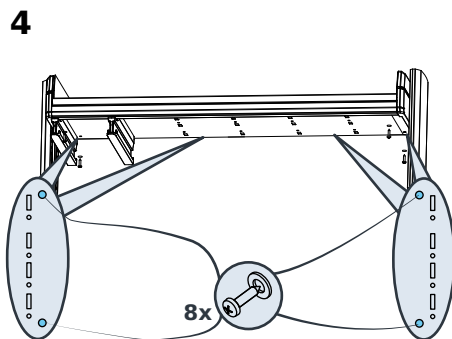
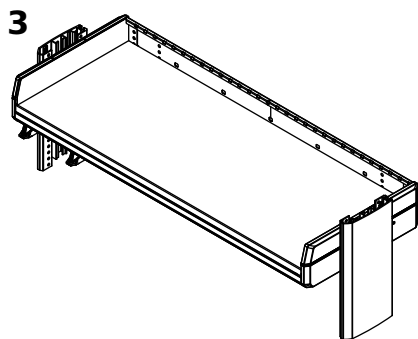
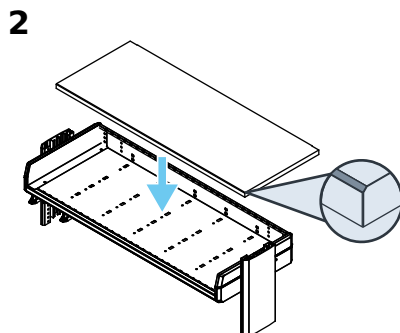
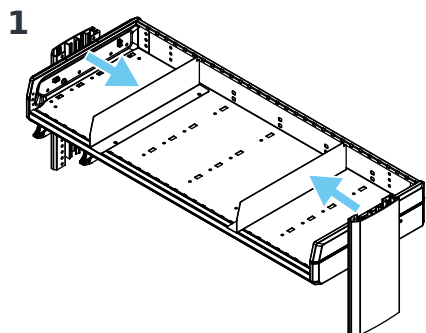
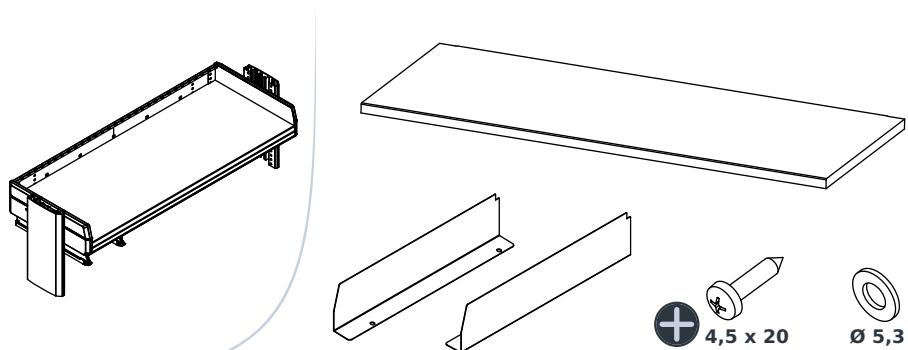

Mounting side profile accessories

Logo



1

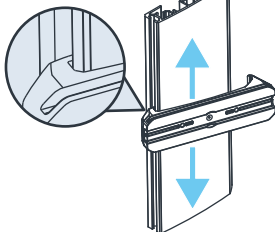

2

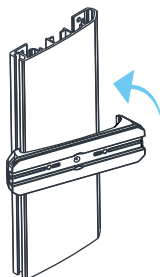

3



Storage pocket

1000012211

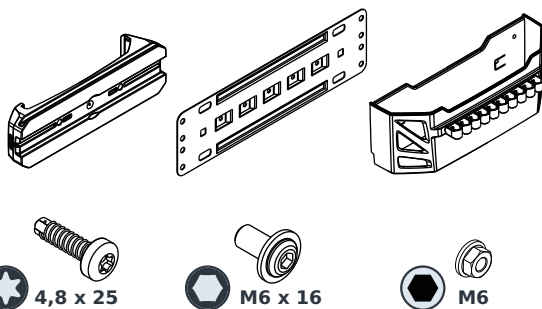
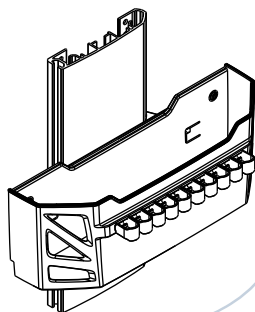

1

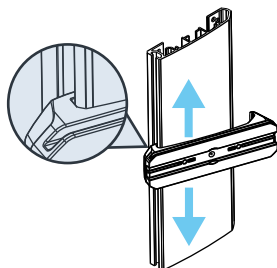

2

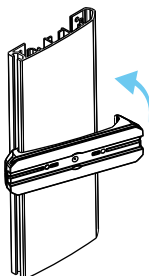

3

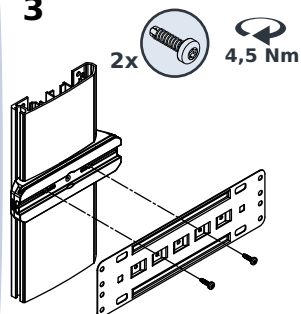

4

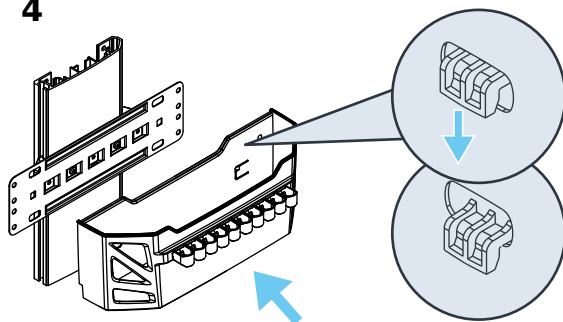

5

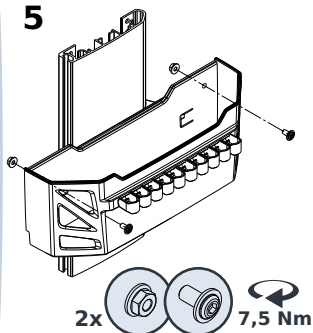

Storage pocket for paperwork

1000012208

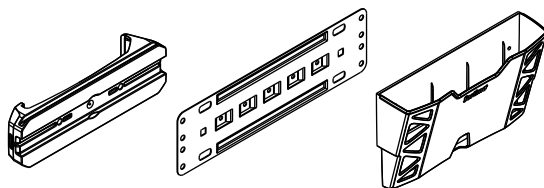
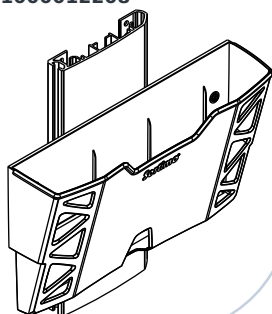

1

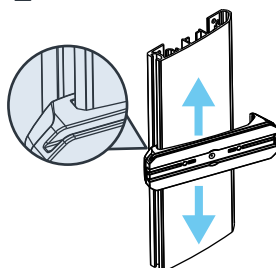

2

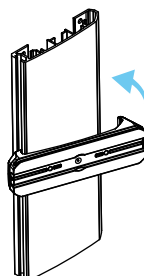

3

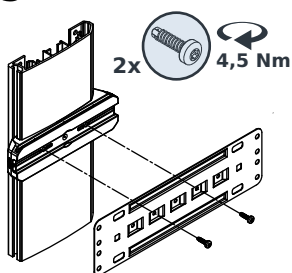

4

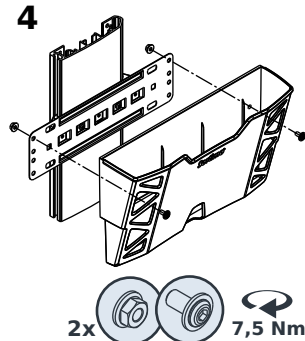

Paper towel dispenser

1000012206

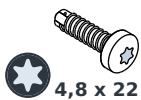
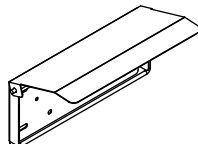
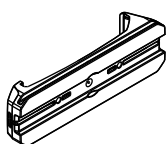
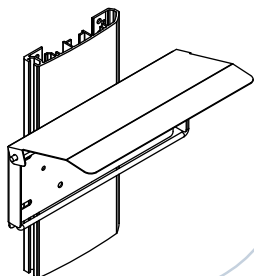

1

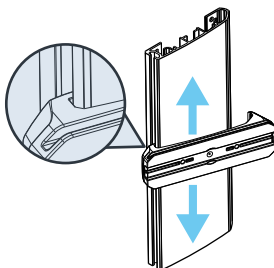

2

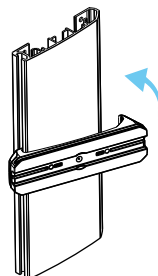

3

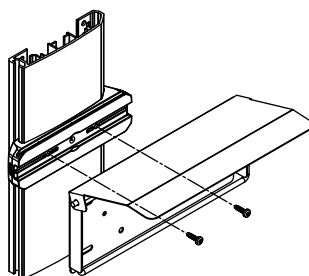

ProSafe lashing rail

1000012755
1000012209
1000012756

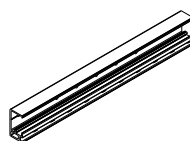
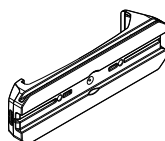
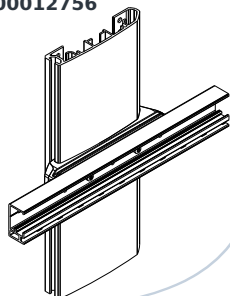

1

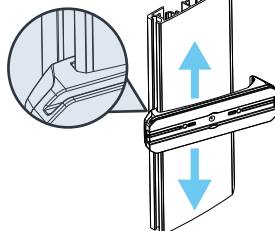

2

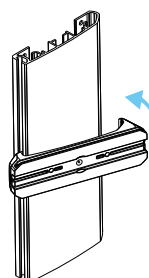

3

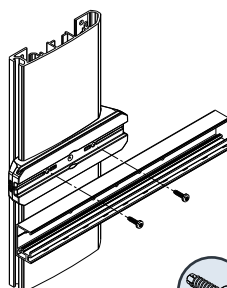

2x



Hook strip

1000013574
1000012210
1000013575

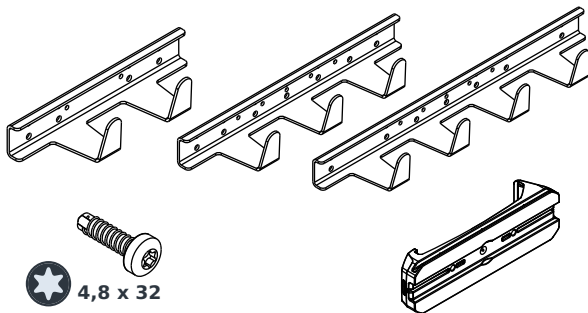
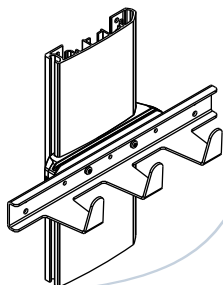

1

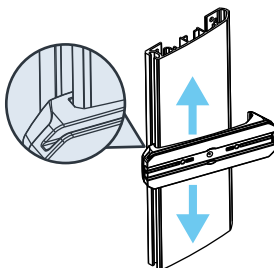

2

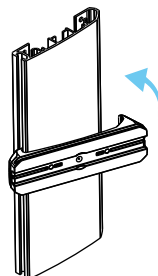

3

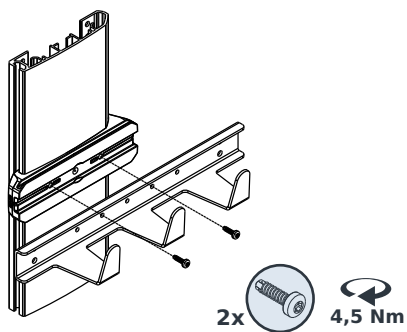

Hose holder

1000012787
1000012207
1000012788

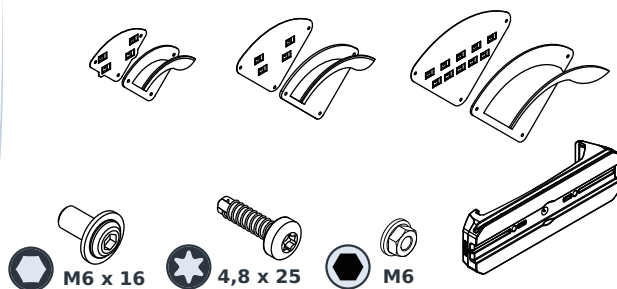
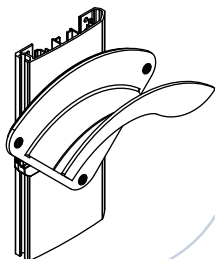

1

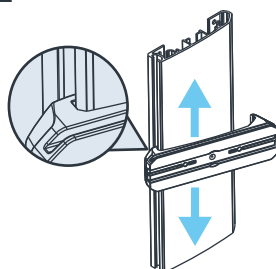

2

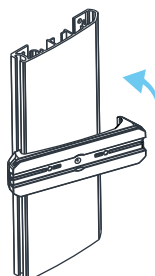

3

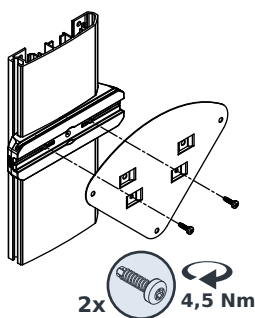

4

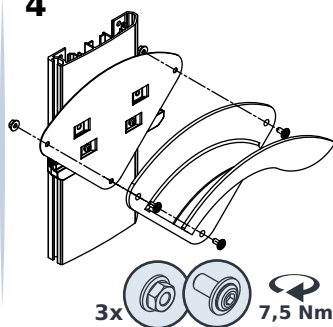

i-BOXX wall holder

1000012904

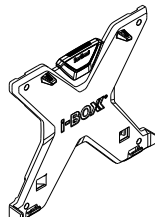
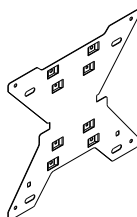
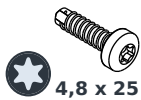
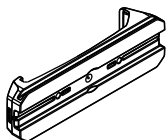
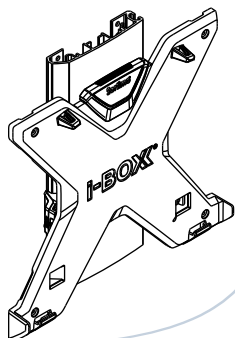

1

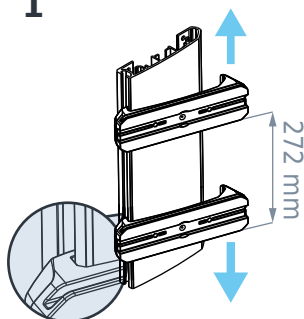

2

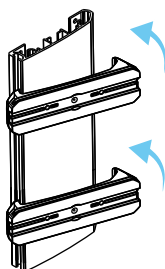

3

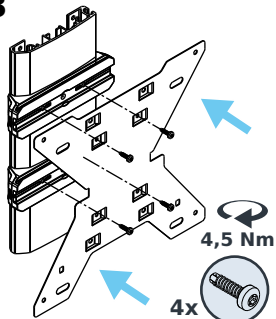

4

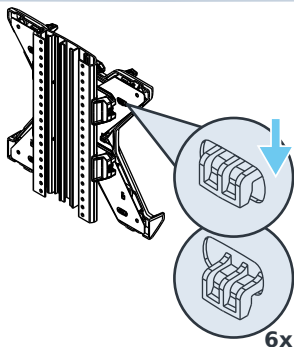
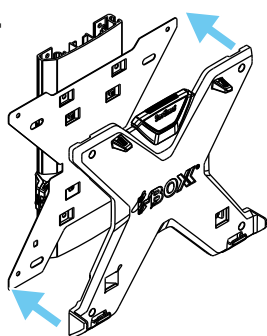

5

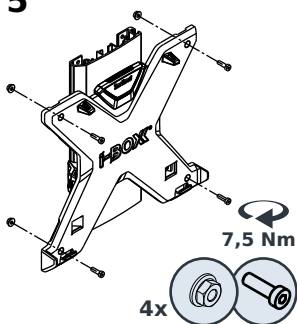

Mounting intermediate profile accessories

Storage pocket

1000013544

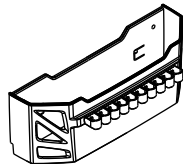
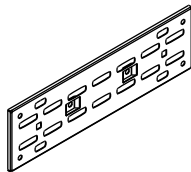
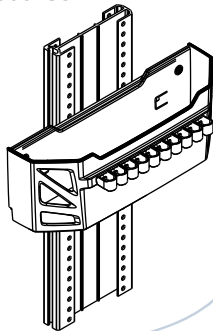

1

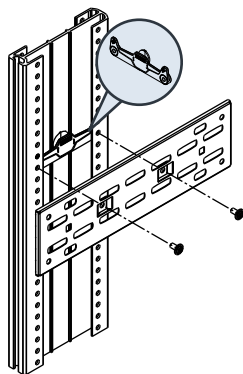

2

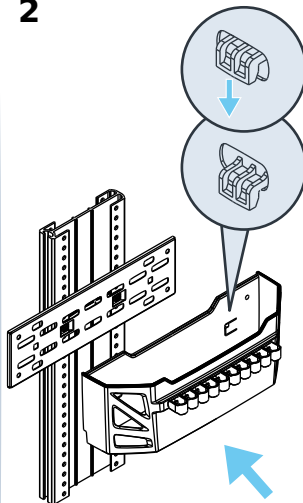

3

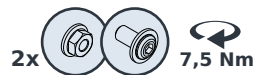
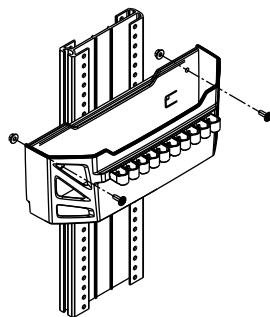

Storage pocket for paperwork

1000013661

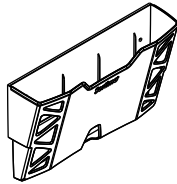
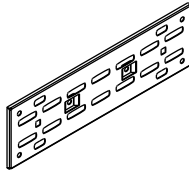
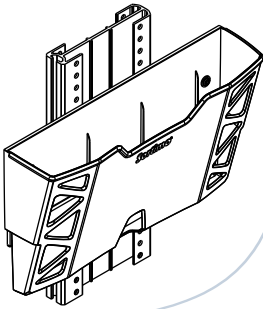

1

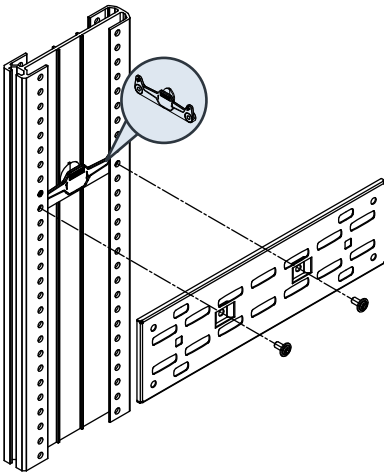

2

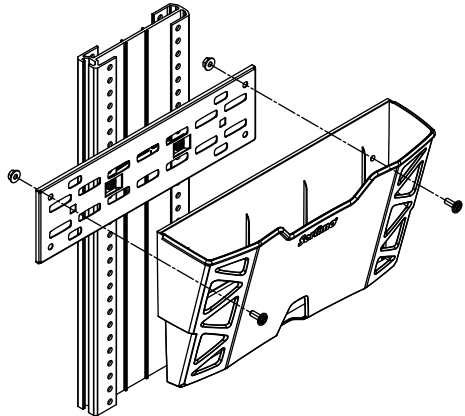

Paper towel dispenser

1000013665

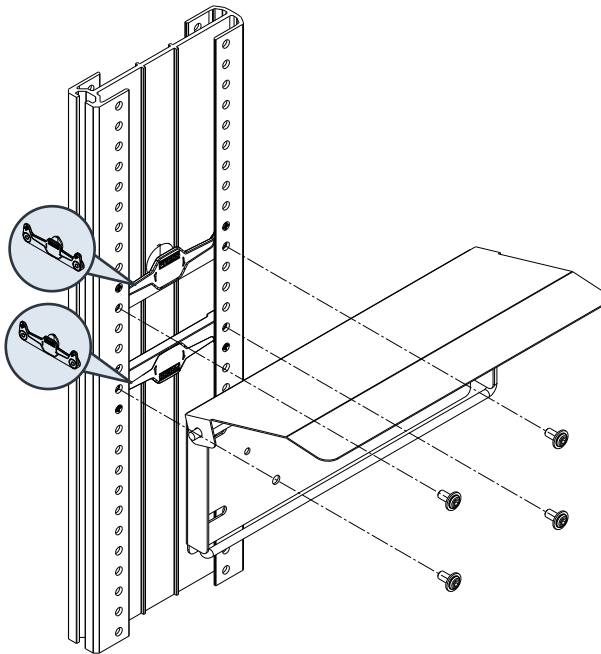
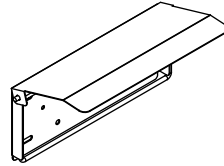
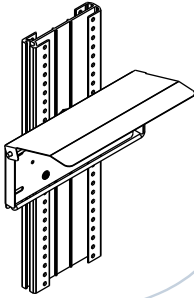

ProSafe lashing rail

1000013670
1000013671
1000013672

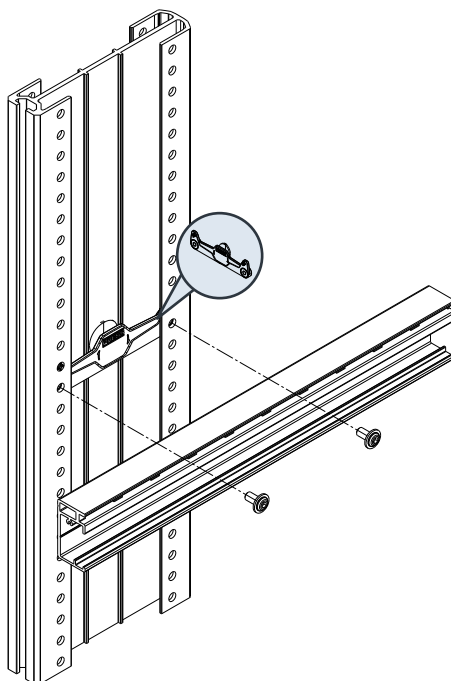
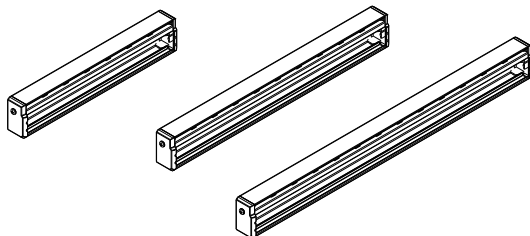
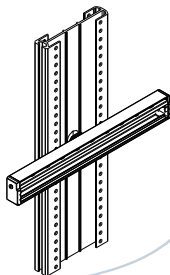

Hook strip

1000013662
1000013663
1000013664

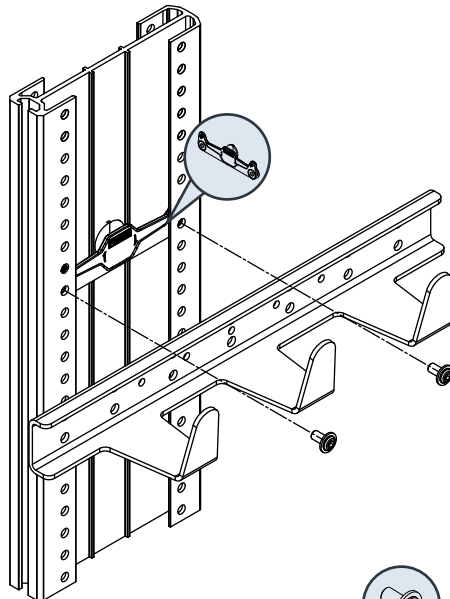
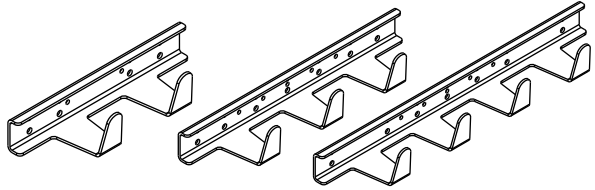
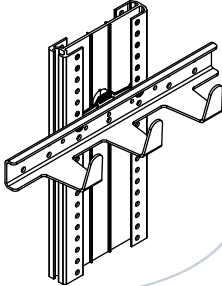

Hose holder

1000013666
1000013667
1000013669

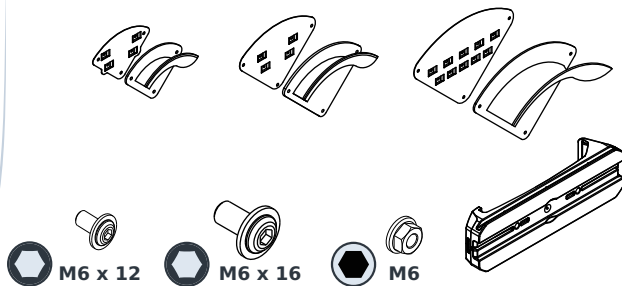
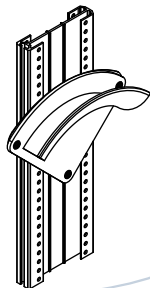

1

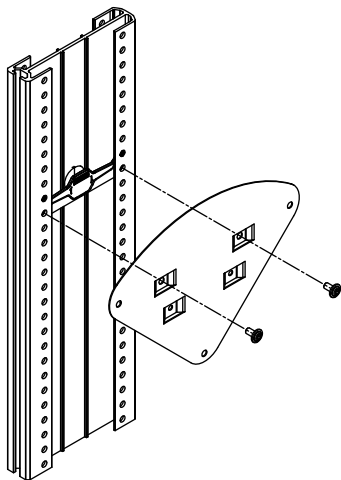

2

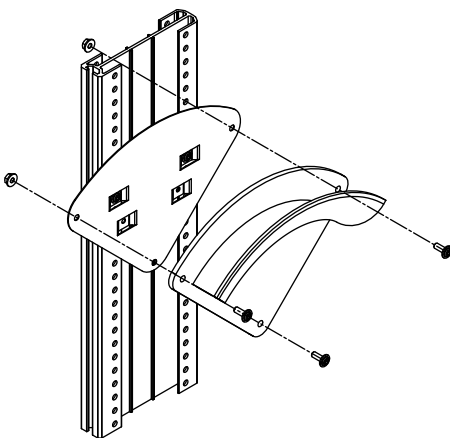

i-BOXX wall holder

1000013673

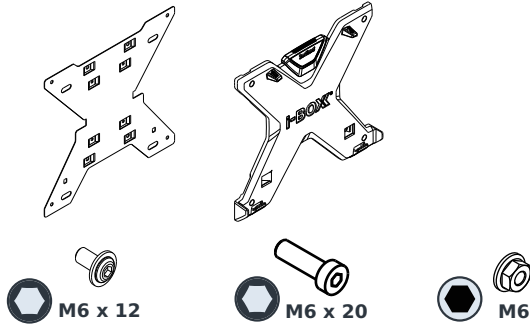
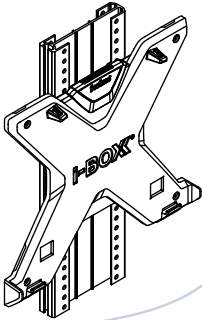

1

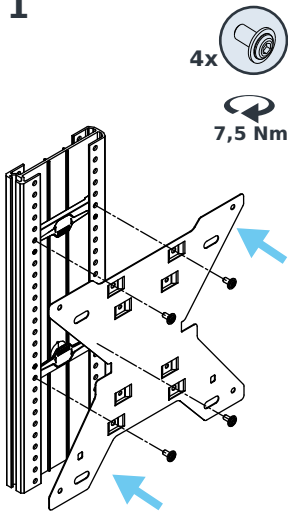

2

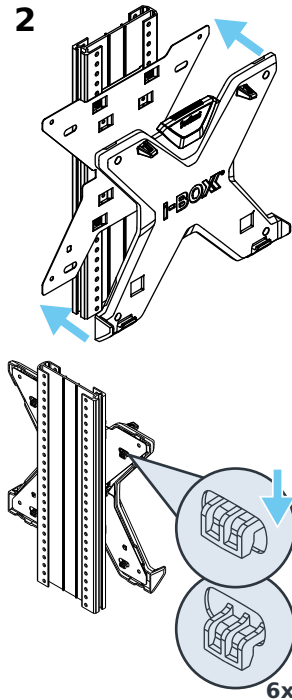

3

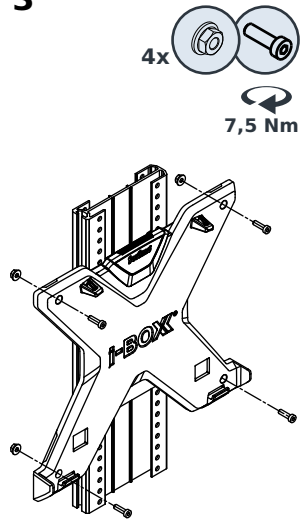

Sortimo International GmbH | Dreilindenstraße 5 | D-86441 Zusmarshausen
direct@sortimo.de | www.sortimo.com